

NR LISTED

OCT 31 1996

United States Department of the Interior
National Park Service

AHPP

NATIONAL REGISTER OF HISTORIC PLACES
REGISTRATION FORM

1. Name of Property

historic name: Chicago Mill Company Office Building

other name/site number: PH0271

2. Location

street & number: 129 N. Washington Street

not for publication: N/A

city/town: West Helena

vicinity: N/A

state: AR county: Phillips code: AR 107 zip code: 72390

3. Classification

Ownership of Property: Private

Category of Property: Building

Number of Resources within Property:

Contributing Noncontributing

<u>1</u>	<u> </u> buildings
<u> </u>	<u> </u> sites
<u> </u>	<u> </u> structures
<u> </u>	<u> </u> objects
<u>1</u>	<u>0</u> Total

Number of contributing resources previously listed in the National Register: N/A

Name of related multiple property listing: Historic Resources of West Helena, Arkansas, 1900-1945

Chicago Mill Company Office Building
Name of Property

Phillips County, AR
County and State

=====

4. State/Federal Agency Certification

=====

As the designated authority under the National Historic Preservation Act of 1986, as amended, I hereby certify that this X nomination request for determination of eligibility meets the documentation standards for registering properties in the National Register of Historic Places and meets the procedural and professional requirements set forth in 36 CFR Part 60. In my opinion, the property X meets does not meet the National Register Criteria. See continuation sheet.

Cathryn A. Slaton
Signature of certifying official

9-4-96
Date

Arkansas Historic Preservation Program
State or Federal agency and bureau

In my opinion, the property X meets does not meet the National Register criteria. See continuation sheet.

Signature of commenting or other official

Date

State or Federal agency and bureau

=====

5. National Park Service Certification

=====

I, hereby certify that this property is:

____ entered in the National Register
____ See continuation sheet.
____ determined eligible for the
National Register
____ See continuation sheet.
____ determined not eligible for the
National Register
____ removed from the National Register
____ other (explain): _____

Signature of Keeper

Date
of Action

Chicago Mill Company Office Building
Name of Property

Phillips County, AR
County and State

=====

6. Function or Use

=====

Historic: COMMERCE/TRADE

Sub: Business

Current: COMMERCE/TRADE

Sub: Business

=====

7. Description

=====

Architectural Classification:

Craftsman

Other Description: N/A

Materials: foundation walls

Brick

roof

Asphalt

Wood/Board-and-batten

other

N/A

Describe present and historic physical appearance.
sheet.

— See continuation

=====

Description

The Chicago Mill Company Office Building is a single-story, wood-frame structure designed in a restrained version of the Craftsman style. It is distinguished by its low, spreading, asphalt-shingle hipped roof that extends out and over the wrap-around front porch. The porch itself is also distinctive, as it extends across the eastern elevation of the building and wraps around to the north. It is supported upon wood box columns, painted white. Wood board-and-batten sheathing covers the entire building, including the later though sympathetic rear addition, and one-over-one wood windows light the interior. A single chimney is placed against the northern wall toward the rear, and the entire building is supported upon brick piers.

=====

8. Statement of Significance

=====

Certifying official has considered the significance of this property in relation to other properties: Locally.

Chicago Mill Company Office Building
Name of Property

Phillips County, AR
County and State

Applicable National Register Criteria: A

Criteria Considerations (Exceptions): N/A

Areas of Significance: INDUSTRY

Period(s) of Significance: c. 1920-1945

Significant Dates: c. 1920

Significant Person(s): N/A

Cultural Affiliation: N/A

Architect/Builder: Unknown

State significance of property, and justify criteria, criteria considerations, and areas and periods of significance noted above.
____ See continuation sheet.

Significance

Criterion A, local significance

The Chicago Mill Company Office Building is locally significant under Criterion A by virtue of its direct associations with the Chicago Mill Company, one of the largest wood processing industries to install a facility in West Helena during its boom years and one of the few to survive the Depression of the 1930's. As such it is associated with the historic context *Historic Resources of West Helena, Arkansas, 1900-1945* as one of the few surviving examples of an historic industrial office building.

9. Major Bibliographical References

See "Historic Resources of West Helena, Arkansas, 1900-1945," Section H.

____ See continuation sheet.

Previous documentation on file (NPS):

Chicago Mill Company Office Building
Name of Property

Phillips County, AR
County and State

preliminary determination of individual listing (36 CFR 67) has been requested.

previously listed in the National Register

previously determined eligible by the National Register

designated a National Historic Landmark

recorded by Historic American Buildings Survey # _____

recorded by Historic American Engineering Record # _____

Primary Location of Additional Data:

X State historic preservation office

Other state agency

Federal agency

Local government

University

Other -- Specify Repository: _____

=====

10. Geographical Data

=====

Acreage of Property: Less than one

UTM References:	Zone	Easting	Northing	Zone	Easting	Northing
A	<u>15</u>	<u>715100</u>	<u>3824800</u>	B	<u>15</u>	_____
C	<u>15</u>	_____	_____	D	<u>15</u>	_____

____ See continuation sheet.

Verbal Boundary Description: ____ See continuation sheet.

Beginning at a point formed by the intersection of the western edge of N. Washington Street with a perpendicular line running parallel with the building's northern elevation and located approximately 25 feet to the north thereof, proceed westerly along said line for approximately 200 feet; thence proceed southerly along a perpendicular line for approximately 200 feet; thence proceed easterly along a perpendicular line for approximately 200 feet to its intersection with the western edge of N. Washington Street; thence proceed northerly along said edge to the point of beginning.

Boundary Justification: ____ See continuation sheet.

This boundary includes all the property historically associated with this resource that retains its integrity.

Chicago Mill Company Office Building
Name of Property

Phillips County, AR
County and State

=====

11. Form Prepared By

=====

Name/Title: Ken Story, National Register/Survey Coordinator

Organization: Arkansas Historic Preservation Program Date: 09/03/96

Street & Number: 323 Center Street, Suite 1500 Telephone: (501) 324-9880

City or Town: Little Rock State: AR Zip: 72201

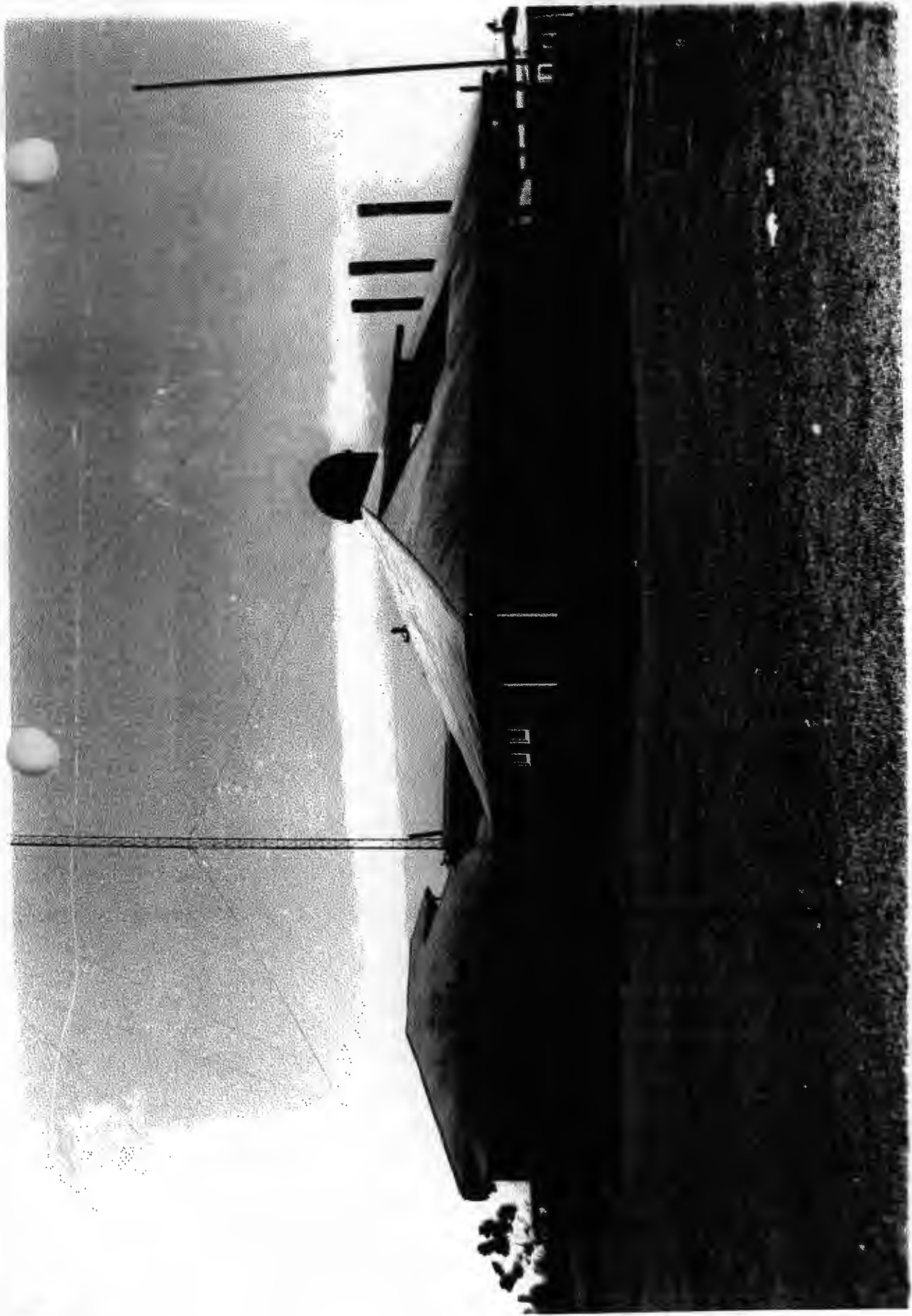

HYDRO RESOURCES
OF HELENA,
AR & SAs
WEST HELENA,
PHILLIPS Co., AR

PH0270

15/716530/

3825000

PH0271

15/715100/

3824800

PH0272

15/717180/

3824245

PH0273

15/717180/

3824320

PH0274

15/717180/

3824465

PH0275

15/717140/

3824760

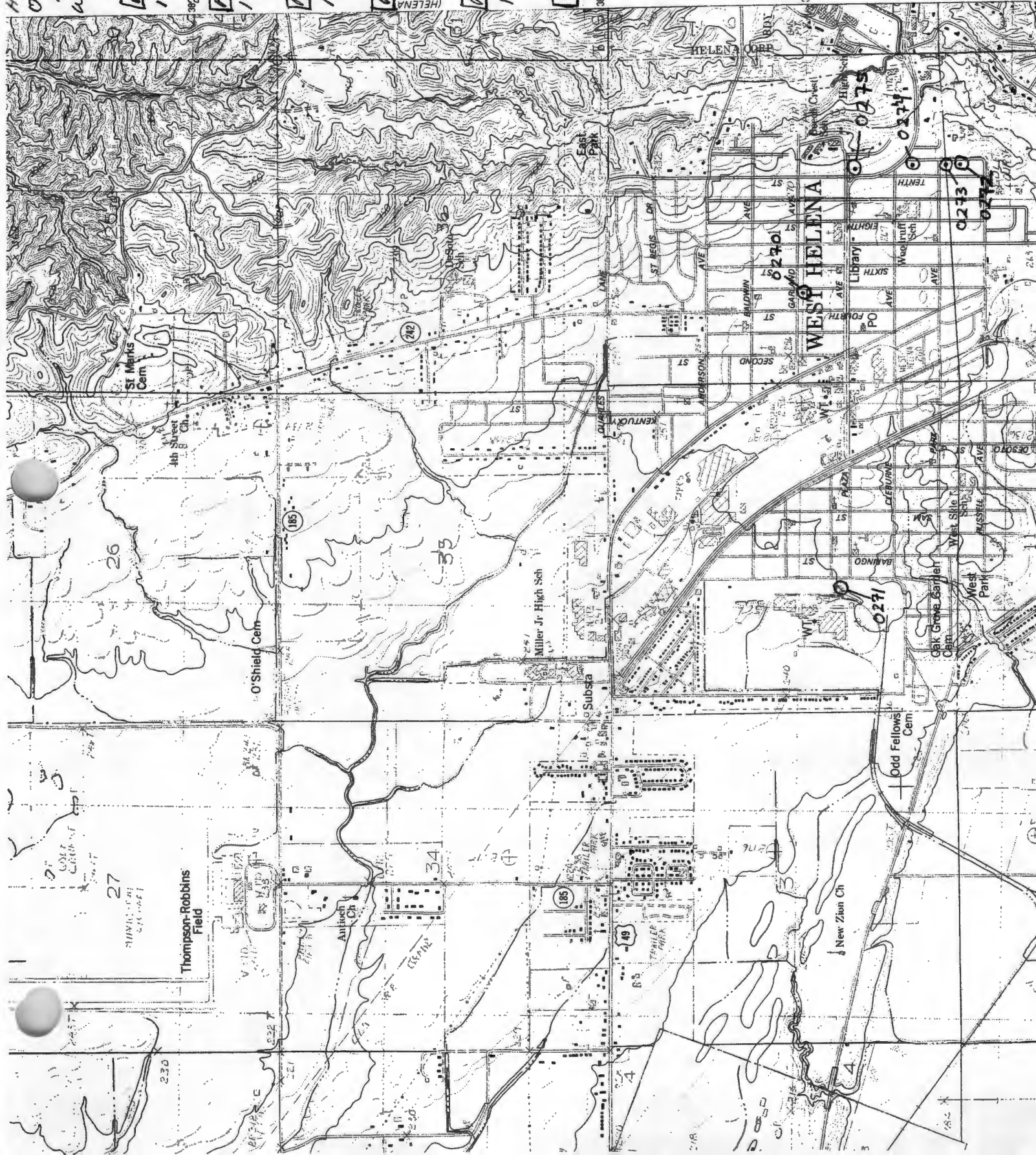

3925

32° 30"

3924