

United States Department of the Interior
National Park Service

NR 8/1/08

National Register of Historic Places Registration Form

This form is for use in nominating or requesting determinations for individual properties and districts. See instructions in *How to Complete the National Register of Historic Places Registration Form* (National Register Bulletin 16A). Complete each item by marking "x" in the appropriate box or by entering the information requested. If an item does not apply to the property being documented, enter "N/A" for "not applicable." For functions, architectural classification, materials, and areas of significance, enter only categories and subcategories from the instructions. Place additional entries and narrative items on continuation sheets (NPS Form 10-900a). Use a typewriter, word processor, or computer, to complete all items.

1. Name of Property

historic name East Broad Street Historic District

other names/site number M10213

2. Location

street & number 100 block E. Broad Street

not for publication

city or town Texarkana

vicinity

state Arkansas code AR county Miller code 091 zip code 71854

3. State/Federal Agency Certification

As the designated authority under the National Historic Preservation Act, as amended, I hereby certify that this nomination
request for determination of eligibility meets the documentation standards for registering properties in the National Register of Historic
Places and meets the procedural and professional requirements set for in 36 CFR Part 60. In my opinion, the property meets
does not meet the National Register criteria. I recommend that this property be considered significant
 nationally statewide locally. (See continuation sheet for additional comments.)

Colbie Matthews
Signature of certifying official/Title

3/14/08
Date

Arkansas Historic Preservation Program

State or Federal agency and bureau

In my opinion, the property meets does not meet the National Register criteria. (See Continuation sheet for additional
comments.)

Signature of certifying official/Title

Date

State or Federal agency and bureau

4. National Park Service Certification

I hereby certify that the property is:

entered in the National Register.

See continuation sheet

determined eligible for the
National Register.

See continuation sheet

determined not eligible for the
National Register.

removed from the National
Register.

other, (explain): _____

Signature of the Keeper

Date of Action

E. Broad Street Historic District
Name of Property

Miller County, Arkansas
County and State

5. Classification

Ownership of Property
(Check as many boxes as apply)

Category of Property
(Check only one box)

Number of Resources within Property
(Do not include previously listed resources in count.)

- private
- public-local
- public-State
- public-Federal

- building(s)
- district
- site
- structure
- object

Contributing	Noncontributing	
--------------	-----------------	--

9	6	buildings
		sites
		structures
		objects
9	6	Total

Name of related multiple property listing
(Enter "N/A" if property is not part of a multiple property listing.)

Number of Contributing resources previously listed in the National Register

Historic Buildings of Texarkana, Arkansas

N/A

6. Function or Use

Historic Functions
(Enter categories from instructions)

COMMERCE/TRADE: Financial Institution, Specialty Store, Department Store, Professional

Current Functions
(Enter categories from instructions)

COMMERCE/TRADE: Financial Institution, Specialty Store, Professional

SOCIAL: Civic

7. Description

Architectural Classification
(Enter categories from instructions)

LATE VICTORIAN: Italianate

LATE 19th & EARLY 20th CENTURY AMERICAN MOVEMENTS: Commercial Style

MODERN MOVEMENT: Art Deco

Materials
(Enter categories from instructions)

foundation Concrete, Brick

walls Brick, Stucco, Stone

roof Asphalt

other

Narrative Description

(Describe the historic and current condition of the property on one or more continuation sheets.)

E. Broad Street Historic District
Name of Property

Miller County, Arkansas
County and State

8. Statement of Significance

Applicable National Register Criteria
(Mark "x" in one or more boxes for the criteria qualifying the property for National Register listing.)

- A** Property is associated with events that have made a significant contribution to the broad patterns of our history.
- B** Property is associated with the lives of persons significant in our past.
- C** Property embodies the distinctive characteristics of a type, period, or method of construction or represents the work of a master, or possesses high artistic values, or represents a significant and distinguishable entity whose components lack individual distinction.
- D** Property has yielded, or is likely to yield, information important in prehistory or history.

Criteria Considerations
(Mark "x" in all the boxes that apply.)

- Property is:
- A** owned by a religious institution or used for religious purposes.
 - B** removed from its original location.
 - C** birthplace or grave of a historical figure of outstanding importance.
 - D** a cemetery.
 - E** a reconstructed building, object, or structure.
 - F** a commemorative property
 - G** less than 50 years of age or achieved significance within the past 50 years.

Levels of Significance (local, state, national)
Local

Areas of Significance (Enter categories from instructions)
Architecture

Commerce

Community Planning & Development

Period of Significance
1886-1958

Significant Dates
1886-1958

Significant Person (Complete if Criterion B is marked)
N/A

Cultural Affiliation (Complete if Criterion D is marked)
N/A

Architect/Builder
N/A

Narrative Statement of Significance
(Explain the significance of the property on one or more continuation sheets.)

9. Major Bibliographical References

Bibliography
(Cite the books, articles, and other sources used in preparing this form on one or more continuation sheets.)

- Previous documentation on file (NPS):**
- preliminary determination of individual listing (36 CFR 67) has been requested
 - previously listed in the National Register
 - Previously determined eligible by the National Register
 - designated a National Historic Landmark
 - recorded by Historic American Buildings Survey # _____
 - recorded by Historic American Engineering Record # _____

- Primary location of additional data:**
- State Historic Preservation Office
 - Other State Agency
 - Federal Agency
 - Local Government
 - University
 - Other
- Name of repository:

E. Broad Street Historic District
Name of Property

Miller County, Arkansas
County and State

10. Geographical Data

Acreage of Property Less than one acre.

UTM References

(Place additional UTM references on a continuation sheet.)

1 15 403081 3698513
Zone Easting Northing
2 _____

3 _____
Zone Easting Northing
4 _____

See continuation sheet

Verbal Boundary Description

(Describe the boundaries of the property on a continuation sheet.)

Boundary Justification

(Explain why the boundaries were selected on a continuation sheet.)

11. Form Prepared By

name/title Sandra Taylor Smith, Preservation Consultant, Ralph S. Wilcox, National Register & Survey Coordinator
organization Prepared For: Arkansas Historic Preservation Program date January 30, 2008
street & number 1500 Tower Building, 323 Center Street telephone (501) 324-9787
city or town Little Rock state AR zip code 72201

Additional Documentation

Submit the following items with the completed form:

Continuation Sheets

Maps

- A USGS map (7.5 or 15 minute series) indicating the property's location
- A Sketch map for historic districts and properties having large acreage or numerous resources.

Photographs

Representative black and white photographs of the property.

Additional items

(Check with the SHPO or FPO for any additional items.)

Property Owner

(Complete this item at the request of SHPO or FPO.)

name Multiple Owners
street & number _____ telephone _____
city or town _____ state _____ zip code _____

Paperwork Reduction Act Statement: This information is being collected for applications to the National Register of Historic Places to nominate properties for listing or determine eligibility for listing, to list properties, and to amend existing listing. Response to this request is required to obtain a benefit in accordance with the National Historic Preservation Act, as amended (16 U.S.C. 470 *et seq.*)

Estimated Burden Statement: Public reporting burden for this form is estimated to average 18.1 hours per response including time for reviewing instructions, gathering and maintaining data, and completing and reviewing the form. Direct comments regarding this burden estimate or any aspect of this form to the Chief, Administrative Services Division, National Park Service, P. O. Box 37127, Washington, DC 20013-7127; and the Office of Management and Budget, Paperwork Reductions Projects (1024-0018), Washington, DC 20303.

United States Department of the Interior
National Park Service

National Register of Historic Places Continuation Sheet

Section number 7 Page 1

SUMMARY

The East Broad Street Historic District is located in Texarkana, Arkansas, a city on the southwest corner of Arkansas. The Texarkana metropolitan area is divided into two cities- Texarkana, Arkansas, and Texarkana, Texas, with separate city governments whose boundary runs through the middle of the downtown commercial district and is called State Line Avenue. Containing fifteen buildings, the East Broad Street Historic District reflects the development of the city as a regional commercial and governmental center for two states.

ELABORATION

The East Broad Street Historic District contains fifteen buildings constructed between 1886 and 1930. Of the fifteen buildings in the district, thirteen (87%) were constructed before 1920. One building was constructed c.1920 and another in 1930. Nine (60%) of the buildings in the district contribute to its historic significance. The six buildings determined non-contributing have been severely altered from their original appearance.

1886-1899

The earliest buildings in the East Broad Street Historic District were constructed in the last two decades of the 19th century. Although non-contributing in the district due to severe alterations from its original appearance, the O'Dwyer and Ahern Building at 110 E. Broad Street, constructed c.1886, is the oldest building in the district. The front elevation of this three-story building has been drastically changed with the application of synthetic siding and new brick. Rear elevation walls, although stuccoed, indicate the original character of the building in the Italianate style tall, narrow windows with slightly arched crowns.

The Smith Drug Company building at 100 E. Broad, was constructed c.1890. Although the front of the building has been modified, the building contributes to the historic significance of the district through its visible side elevation facing State Line Avenue, which reveals Italianate style design. Thirteen bays marked by two-story brick pilasters contain narrow window openings with segmental arched crowns. Three rows of brick bands highlight the cornice on this side of the building, indicating the original appearance of the front of the building.

Another c.1890 building in the district, located at 118 E. Broad is a two-story brick vernacular commercial design. A decorative brick pattern cornice provides detail on the upper portion of the building. The storefront remains intact with a center display window and recessed entries on either side.

Constructed in 1899, the building at 115 E. Broad has been severely altered from its original appearance with the infill of fenestration on both first and second stories on the front and back.

United States Department of the Interior
National Park Service

National Register of Historic Places Continuation Sheet

Section number 7 Page 2

1900-1919

Nine (60%) of the fifteen buildings in the district were constructed from 1900 to 1919. Five of these early 20th century buildings were built in 1900. The building at 104 E. Broad, c.1900, has two recessed storefronts on the ground floor. Nine double-hung, one-over-one windows span the width of the second story front elevation. Simple brick pattern with cast concrete insets at corners provides the minimal decorative element on this building. The brick parapet is capped by cast concrete. This building contributes to the significance of the district in its simple brick vernacular commercial design.

Higgin's Dry Goods Building at 114 E. Broad was constructed c.1900. It is a simple two-story brick building with minimal detail typical of many vernacular commercial buildings constructed in the early decades of the twentieth century.

The two-story brick building at 119 E. Broad was also built c.1900. It presents its character through brick pilasters with cast concrete bases on the second story and a projecting cast concrete cornice. Virtually identical in appearance, the building at 121 E. Broad Street also features cast concrete cornice and brick pilasters.

The only non-contributing of the five buildings in the district that were constructed c. 1900 is located at 123 E. Broad. The side elevation facing Olive Street reveals segmental arched crowns on second story windows, but the front of the building has been drastically changed with the application of new materials and alteration of second story windows and the storefront.

The State National Bank at 101-105 E. Broad Street was constructed c.1904. Five stories in height, the building is a flat-iron shape on the most prominent corner of State Line Avenue and Broad Street. The building has been drastically altered from its original appearance with the application of cast concrete panels and does not contribute to the historic character of the district.

The two-story brick buildings at 111-113 and 117 E. Broad were both constructed c.1910, but have been remodeled and alterations disguise the original character of these buildings.

In contrast, the building at 116 E. Broad is a two-story brick commercial structure that retains its original features and appearance. Constructed in 1917, this building features an original wood frame storefront with kickplate and multi-pane clear story windows. Brick pilasters with cast concrete capitals and bases flank the storefront opening. A projecting cast concrete cornice is denoted by four fluted, cast concrete pilasters with Ionic capitals. A cast concrete ledge runs below second story windows marked on each end by decorative cast concrete rectangles.

United States Department of the Interior
National Park Service

National Register of Historic Places Continuation Sheet

Section number 7 Page 3

1920-1930

Constructed c.1920, the building at 122 E. Broad is located on the northeast corner of E. Broad and Olive Streets. The two-story building features Art Deco style detail in its geometric front detail on pilasters separating six second floor bays. The front is covered in cut stone block and wraps around to the east side. Although second story windows have been changed, the overall Art Deco application to the building is retained and this building contributes to the character of the district as the only example of Art Deco style influence.

The c.1930 building at 108 E. Broad is a simple two-story brick commercial building with little ornamentation. Second story windows have been infilled, but the building's general vernacular design contributes to the significance of the district.

INTEGRITY

The fifteen buildings in the 100 block of E. Broad Street convey the historic character of the district in their orientation and continualness. Ranging in dates of construction from 1886 to 1930, these buildings represent the core of Texarkana's historic downtown commercial fabric.

United States Department of the Interior
National Park Service

National Register of Historic Places Continuation Sheet

Section number 8 Page 1

SUMMARY

The East Broad Street Historic District is located in Texarkana, Arkansas, a city on the southwest corner of Arkansas. The Texarkana metropolitan area is divided into two cities- Texarkana, Arkansas, and Texarkana, Texas, with separate city governments whose boundary runs through the middle of the downtown commercial district and is called State Line Avenue. Containing fifteen buildings, the East Broad Street Historic District reflects the development of the city as a regional commercial and governmental center for two states. The East Broad Street Historic District is being submitted as part of the multiple property nomination *The Commercial Buildings of Texarkana, Arkansas* and is eligible under **Criterion A** and **Criterion C** with **local significance**.

ELABORATION

The early history of Texarkana is inextricably linked to construction of the railroad to the area. The city of Texarkana grew out of construction camps that were established at the western end of the Cairo & Fulton railroad line and the eastern end of the Texas & Pacific line. Both railroad companies began selling lots near the rail lines on both the Arkansas and Texas sides. Texarkana sits astride the boundary between Arkansas and Texas, and is formally two cities in two states. State Line Avenue runs through the middle of the combined business section of Texarkana. Situated in the extreme southwest corner of Arkansas, Texarkana is less than thirty miles from Louisiana. It is fairly accepted that the name Texarkana was derived from the three states.

The coming of the railroad to southwest Arkansas opened the opportunity to harvest the vast timberlands of southern Arkansas. The railroads enabled the lumber to be shipped to distant markets and local industry boomed. Nearby farmers also found the railroad presented opportunities for them to ship cotton and other products. The railroad brought an influx of new residents to the town. Those who had invested in the railroad and timberland in the area gained great wealth and were able to build substantial businesses and homes in the town.

As an important railroad junction, the city grew rapidly from its beginnings in 1873, and by the 1920s, Texarkana was a major railroad hub in its tri-state location. The downtown flourished with hotels, restaurants and entertainment. The city is laid out along the angle of the railroad tracks with Union Station straddling the southern end of State Line Avenue. Although laid out in a grid pattern, the streets of downtown Texarkana run diagonally, northeast to southwest. Warehouses and industrial buildings were located along the rail lines on Front Street, many of which have been razed. Broad Street, one block north of Front Street became the center of business and retains much of its built environment.

United States Department of the Interior
National Park Service

National Register of Historic Places Continuation Sheet

Section number 8 Page 2

During the years of World War II, U.S. Army ammunition plants and the importance of the presence of the railroad for transportation of military, goods and supplies caused business and employment in Texarkana to remain stable.

Texarkana continued to experience growth after the end of World War II as the city spread. The center of commerce remained downtown until the 1960s, when U.S. Interstate 30 was constructed to the north of the city limits. Systematically, growth and relocation to the new corridor of transportation has affected the growth patterns of the city. Many downtown businesses relocated near the new highway. However, downtown remained and continues to remain the governmental center of the city with the presence of both municipalities' city halls, and Federal government offices. Although not still the vibrant retail business center it once was, downtown Texarkana still retains much of its historic commercial fabric.

The commercial structures of the E. Broad Street Historic District are significant to the early growth of Texarkana as they housed the local service centers, including office space, retail outlets, and financial institutions. These buildings maintain integrity and best represent the importance of E. Broad Street in the development and growth of Texarkana. Of the fifteen buildings in the district, thirteen (87%) were constructed before 1920. One building was constructed c.1920 and another in 1930. Nine (60%) of the buildings in the district contribute to its historic significance. The six buildings determined non-contributing are older than fifty years, but have been severely altered from their original appearance.

The history of the individual buildings in the 100 block of E. Broad Street illustrate the development of the city. For example, the oldest extant building in the E. Broad Street Historic District, the O'Dwyer and Ahern Building at 110 E. Broad, was built by Irish immigrants to house their dry goods store. The O'Dwyer and Ahern Store was a landmark business in downtown Texarkana, remaining in the building until the 1930s when the business closed. The local Masonic Lodge used the building in the early 1940s, then Dillard's Department Store occupied the building from 1945 to 1978. The current china and glassware business located in the building has been there since 1979, indicating the continued stability of this block of E. Broad.

The Smith Drug Store Building at 100 E. Broad, constructed c.1890, was originally used as a drug store and physician's office. Later the building housed a variety of retail stores including a clothing store on the ground floor with law and insurance offices on the second floor. Similarly descriptive of the types of goods and services utilized by the citizens of Texarkana and surrounding areas is the Nathan's Clothing Co. Building at 104 E. Broad. Constructed c.1900, the building housed a men's clothier on the first floor through the 1920s, with a photographer's studio on the second floor. In the 1940s, the building was used as a theater and from 1954 to 2004 a men's clothing company again occupied the building. A false front was added to the building in the 1960s, but has been removed, revealing the original brick wall.

United States Department of the Interior
National Park Service

National Register of Historic Places Continuation Sheet

Section number 8 Page 3

Commonly seen throughout the country in the 1960s, commercial buildings in downtowns were often altered with the application of a false front, often of aluminum, but almost always concealing the true character of the building. This attempt to keep with the times was often a direct result of competition with strip shopping centers and malls being constructed on the edge of the city near the new interstate highway. One of the most dramatic of the changes to buildings along E. Broad Street is seen in the stucco false façade on the State National Bank Building at 101-105 E. Broad. This five-story building is located on one of the most important intersections in downtown Texarkana at E. Broad and State Line Avenue. The building comes to a triangular point on the corner, adapting to the triangular-shaped lot. Of brick construction, the building retains its original facades under the stucco walls. Five-story arched bays on the false fronts mimic the original window bays with arched tops.

Although most of the buildings in the 100 block of E. Broad are simple vernacular early twentieth-century commercial style, there are some distinct architectural influences. Constructed in 1917, the building at 116 E. Broad displays Classical elements including pilasters, and an egg and dart cornice. Art Deco designs are seen on the upper portion of pilasters on the building at 122 E. Broad Street.

SIGNIFICANCE

The E. Broad Street Historic District is being nominated for inclusion in the National Register of Historic Places under **Criterion A** for the events that have occurred in this block that contribute to an understanding of local history and broader patterns of history. It is also nominated under **Criterion C** for its architecture that reflects a type, period, and or method of construction. The historic built environment of this district retains its architectural integrity and contributes to the district's period of significance that spans 1886 to 1930. Submitted as part of the multiple property nomination *Historic Buildings of Texarkana, Arkansas*, the E. Broad Street Historic District is being nominated with **local significance**.

E. Broad Street Historic District
Name of Property

Miller County, Arkansas
County and State

United States Department of the Interior
National Park Service

National Register of Historic Places Continuation Sheet

Section number 9 Page 1

BIBLIOGRAPHY

Arkansas Historic Preservation Program, Architectural Resources Forms for buildings in the 100 block E. Broad Street, Texarkana, Miller County.

Sanborn Fire Insurance Maps for Texarkana, Arkansas: 1923, 1923/50, 1923/53.

E. Broad Street Historic District

Name of Property

Miller County, Arkansas

County and State

United States Department of the Interior
National Park Service

National Register of Historic Places Continuation Sheet

Section number 10 Page 1

VERBAL BOUNDARY DESCRIPTION

South ½ Block 73 and North ½ Block 75, Original Town of Texarkana, Arkansas

BOUNDARY JUSTIFICATION

The boundaries of the E. Broad Street Historic include the most contiguous and significant grouping of historic commercial buildings in downtown Texarkana, Arkansas.

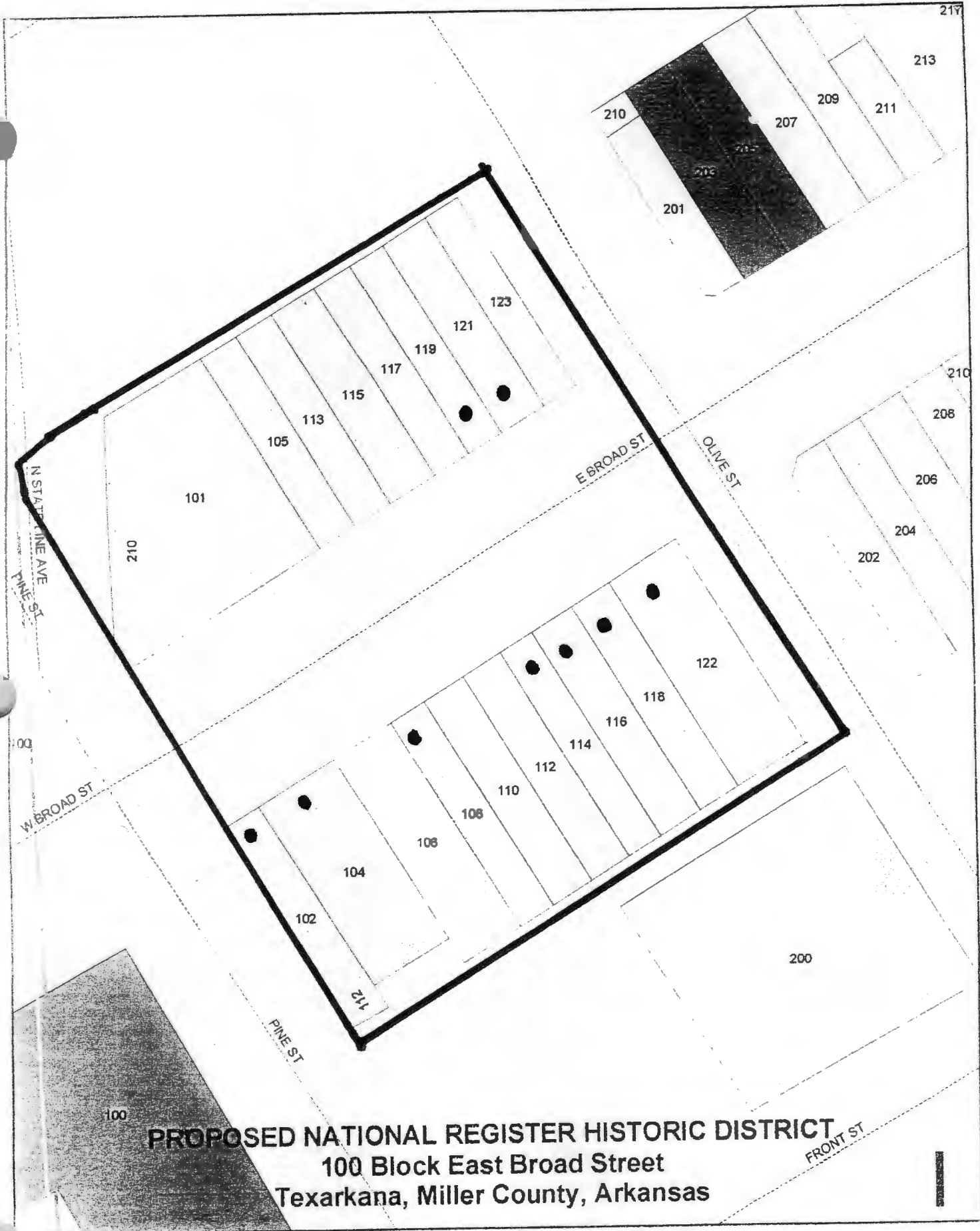

PROPOSED NATIONAL REGISTER HISTORIC DISTRICT
100 Block East Broad Street
Texarkana, Miller County, Arkansas

● *Contributing*





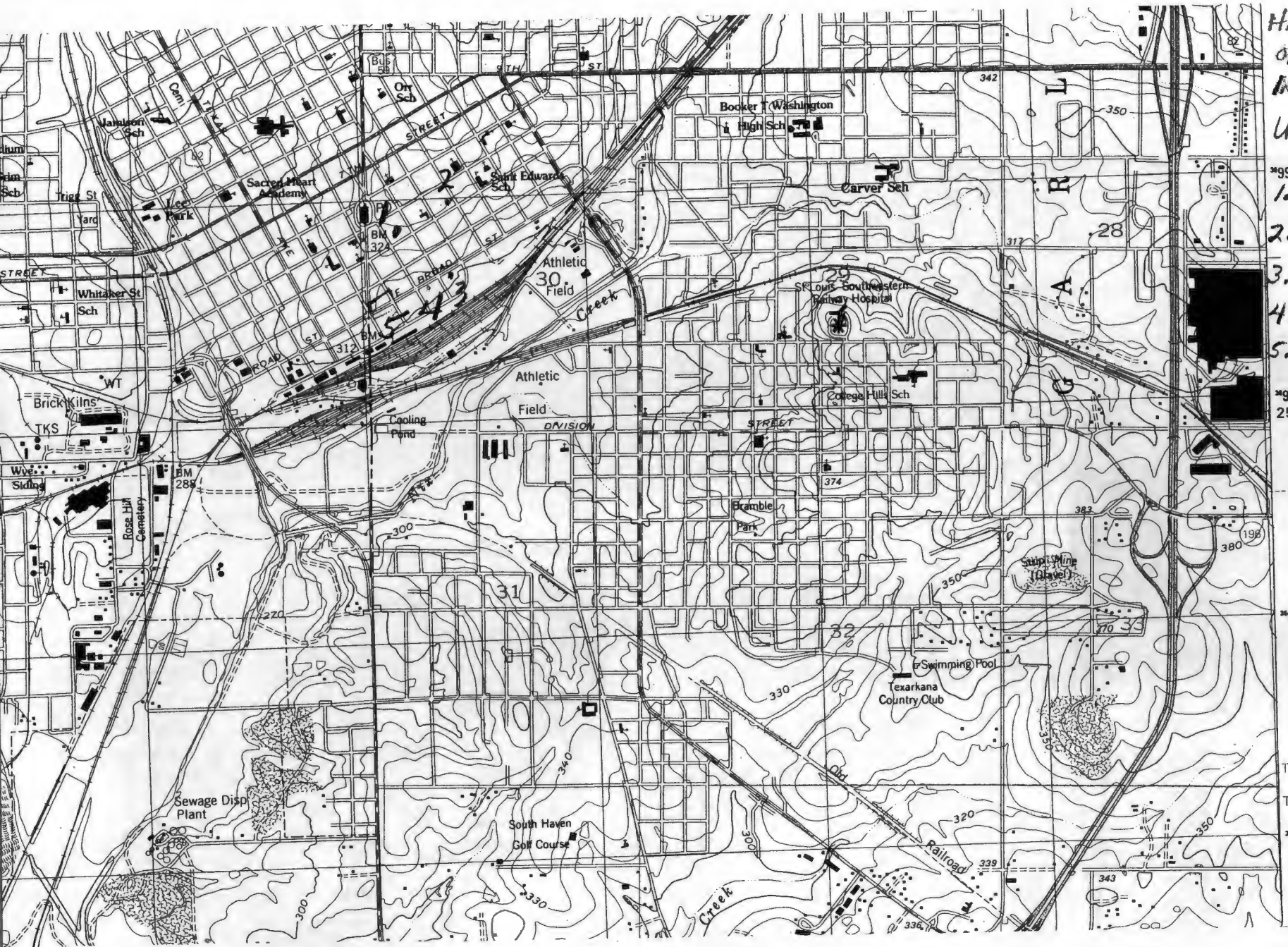

Historic Buildings
of Texarkana, Ark
Miller Co., Ark
UTM References

- *99
1. 15/403318/3698613
- 2. 15/403466/3698918
- 3. 15/403415/3698692
- 4. 15/403318/3698613
- 5. 15/403061/3698513

*98
25'

*97

T 15 S

T 16 S

*96

