

16-14-1045-41

Form 10-300
(Rev. 6-72)

UNITED STATES DEPARTMENT OF THE INTERIOR
NATIONAL PARK SERVICE

**NATIONAL REGISTER OF HISTORIC PLACES
INVENTORY - NOMINATION FORM**

(Type all entries complete applicable sections)

COUNTY:	Craighead
FOR NPS USE ONLY	
ENTRY DATE	

1. NAME

COMMON:

FRIERSON

CG0010

AND/OR HISTORIC:

2. LOCATION

STREET AND NUMBER:

1112 South Main Street

CITY OR TOWN:

Jonesboro

CONGRESSIONAL DISTRICT:

First

STATE

Arkansas

CODE

05

COUNTY:

Craighead

CODE

031

3. CLASSIFICATION

CATEGORY (Check One)	OWNERSHIP	STATUS	ACCESSIBLE TO THE PUBLIC
<input type="checkbox"/> District <input type="checkbox"/> Site <input type="checkbox"/> Object	<input type="checkbox"/> Public <input checked="" type="checkbox"/> Private <input type="checkbox"/> Both	<input type="checkbox"/> Occupied <input checked="" type="checkbox"/> Unoccupied <input type="checkbox"/> Preservation work in progress	Yes: <input checked="" type="checkbox"/> Restricted <input type="checkbox"/> Unrestricted <input type="checkbox"/> No
PRESENT USE (Check One or More as Appropriate)			
<input type="checkbox"/> Agricultural <input type="checkbox"/> Commercial <input type="checkbox"/> Educational <input type="checkbox"/> Entertainment	<input type="checkbox"/> Government <input type="checkbox"/> Industrial <input type="checkbox"/> Military <input type="checkbox"/> Museum	<input type="checkbox"/> Park <input checked="" type="checkbox"/> Private Residence <input type="checkbox"/> Religious <input type="checkbox"/> Scientific	<input type="checkbox"/> Transportation <input type="checkbox"/> Other (Specify) _____ _____
<input type="checkbox"/> Comments _____ _____			

4. OWNER OF PROPERTY

OWNER'S NAME:

Mrs. Margaret Cherry

STREET AND NUMBER:

CITY OR TOWN:

Williamsburg

STATE:

Virginia

CODE

51

5. LOCATION OF LEGAL DESCRIPTION

COURTHOUSE, REGISTRY OF DEEDS, ETC:

Craighead County Courthouse

STREET AND NUMBER:

CITY OR TOWN:

Jonesboro

STATE

Arkansas

CODE

05

6. REPRESENTATION IN EXISTING SURVEYS

TITLE OF SURVEY:

DATE OF SURVEY:

☐ Federal

☐ State

☐ County

☐ Local

DEPOSITORY FOR SURVEY RECORDS:

STREET AND NUMBER:

CITY OR TOWN:

STATE:

CODE

SEE INSTRUCTIONS

STATE

COUNTY

EN

NUMBER

DATE

FOR NPS USE ONLY

7. DESCRIPTION

CONDITION	(Check One)					
	<input type="checkbox"/> Excellent	<input type="checkbox"/> Good	<input checked="" type="checkbox"/> Fair	<input type="checkbox"/> Deteriorated	<input type="checkbox"/> Ruins	<input type="checkbox"/> Unexposed
	(Check One)			(Check One)		
	Altered	<input type="checkbox"/> Unaltered		<input type="checkbox"/> Moved	<input checked="" type="checkbox"/> Original Site	

DESCRIBE THE PRESENT AND ORIGINAL (if known) PHYSICAL APPEARANCE

The Frierson House is a large two-storey frame house with hipped roof and three dormers, a two-storey gallery on the west or front side with a one-storey gallery along the north and east sides of the house. The front two-storey gallery is supported on four Ionic style columns with a balustrade rail of turned individual balusters on both first and second floors, with a third balustrade crowning the flat roof of the gallery. The one-storey gallery on the side and back of the house is supported on simple Roman Doric style columns, also with a balustrade railing. The entablature of the main house is punctuated at widely spaced intervals with simple brackets with a bracket spaced on either side of the upstairs windows which join this entablature. The entablature around the front gallery had brackets also, two spaced over each of the outer columns and three spaced above each of the two inner columns. The ceilings of both the upper and lower front galleries are paneled in an unusual and deliberately irregular pattern. The main front entrance is recessed, being simple in basic design with a three segment transom and sidelights. This entrance is recessed with convex curved paneling reaching from two simple pilasters on either side back to the face of the entrance itself. The side and rear gallery has evenly spaced brackets with a simple beaded ceiling. All of the windows are single light, double hung sash with the windows on either side of the main entrance being wider than the rest used in the house. A matching entrance to the one below is located on the second gallery of the west front of the house with two large windows, one on either side. An open terrace with a wood balustrade rail connects the west front two-storey gallery at the main floor level with the side one-storey gallery.

The interior of the house is presently laid out in a typical fashion used primarily before the Civil War, i.e., with center hall and two rooms opening on either side of the center hall. The U-shaped main stair is located at the east back end of this main center hall with a single landing half-way up on which is located a large stained glass window. This is the only stained glass window located in the house and is of art nouveau design. The fireplaces in the two north rooms are in the corner of each room, back to back,

SEE IN
UNCTIONS

NATIONAL REGISTER OF HISTORIC PLACES
INVENTORY - NOMINATION FORM

STATE	Arkansas
COUNTY	Craighead
FOR NPS USE ONLY	
DATE	

(Continuation Sheet)

(Number all entries)

7. Description Continued:

while the fireplaces for the two south rooms are located back to back in the center of the wall between them. The rear ell contains a butler's pantry and kitchen on the southeast corner of the house with a small porch at the far end. The one-storey gallery also runs along the north side of this kitchen connecting with the gallery running along the east side of the house. The second floor contains four large bedrooms plus several smaller rooms. The interior woodwork is mainly natural varnished wood with hardwood floors. The mantels are natural finished wood with those on the main floor having beveled edge mirrors incorporated into the overmantel. Some of the woodwork in the back part of the house has been painted. The four main downstairs rooms of the house have combination gas and electric lighting fixtures, still complete with the gas shades and smaller electric shades.

The Frierson House is a good example of a home that reflects the varying tastes and needs of the families and occupants who have lived there over a period of years. In spite of the fact that the house has been altered it nevertheless has a well coordinated appearance in its present state. The large tree studded grounds add immeasurably to the overall impression and create a perfect setting for a gracious old home that has served its past occupants well and can serve still future occupants in large measure.

8. SIGNIFICANCE

PERIOD (Check One or More as Appropriate)

☐ Pre-Columbian

☐ 16th Century

☐ 18th Century

☐ 20th Century

☐ 15th Century

☐ 17th Century

☒ 19th Century

SPECIFIC DATE(S) (If Applicable and Known)

AREAS OF SIGNIFICANCE (Check One or More as Appropriate)

Aboriginal

☐ Prehistoric

☐ Historic

☐ Agriculture

☒ Architecture

☐ Art

☐ Commerce

☐ Communications

☐ Conservation

☐ Education

☐ Engineering

☐ Industry

☐ Invention

☐ Landscape

☐ Architecture

☐ Literature

☐ Military

☐ Music

☒ Political

☐ Religion/Philosophy

☐ Science

☐ Sculpture

☒ Social/Humanitarian

☐ Theater

☐ Transportation

☐ Urban Planning

☐ Other (Specify)

STATEMENT OF SIGNIFICANCE

It is impossible to accurately pin-point the date of construction of the house, either by documentary or architectural evidence. There are no surviving documents which would provide a clue as to when the house was built and the architectural style is such that it could have been built anywhere from 1870 to 1910. Local informants state that the house was built in the 1880's. Some architectural details, however, point to a later date. These details, admittedly, may have come into being during the course of later day alterations.

The house, as it stands now, is an excellent example of the type of town house that was being built in the growing commercial cities of the Post Civil War Period. The development of share-cropping as an economic necessity immediately after the Civil War meant the death of the plantation system and the "main house". As the larger landowners prospered, in the two decades following the Civil War, they often built a new house in town and moved there with their families. In most cases the old plantation homes were razed and even the old "house lot" put under cultivation. The Frierson House is an excellent example of the "town house".

The Frierson House is important to the people of the city of Jonesboro. To them it is a nostalgic link with their past, which exists in a city that modern day living and a growing State University complex is rapidly changing.

Historically its significance is slight. Governor Francis Cherry was a resident and conducted his successful political campaign from the old house; an event which adds to the local associations, but does not imbue it

SEE INSTRUCTIONS

UNITED STATES DEPARTMENT OF THE INTERIOR
NATIONAL PARK SERVICE

NATIONAL REGISTER OF HISTORIC PLACES
INVENTORY - NOMINATION FORM

(Continuation Sheet)

STATE	
Arkansas	
Craighead	
FOR NPS USE ONLY	
ENTRY NUMBER	DATE

(Number all entries)

8. Significance Continued:

with any special state or national distinction. The importance of the house, to the local people, is perhaps only symbolic. Symbolic of a social phase in their history which they would like to retain.

9. MAJOR BIBLIOGRAPHICAL REFERENCES

Arkansas Democrat, March 11, 1884; April 14, 1884.
 Arkansas Gazette, January 17, 1947; January 19, 1947;
 November 17, 1951; July 21, 1971.
 Arkansas History Commission. Arkansas Handbook, 1939-1940
 ed., 1941-1942 ed. Little Rock: Arkansas History
 Commission.
Bench and Bar of Arkansas. Little Rock: 1935.
Book of Arkansas. Little Rock: 1913.

10. GEOGRAPHICAL DATA

LATITUDE AND LONGITUDE COORDINATES DEFINING A RECTANGLE LOCATING THE PROPERTY			O R	LATITUDE AND LONGITUDE COORDINATES DEFINING THE CENTER POINT OF A PROPERTY OF LESS THAN TEN ACRES		
CORNER	LATITUDE Degrees Minutes Seconds	LONGITUDE Degrees Minutes Seconds		LATITUDE Degrees Minutes Seconds	LONGITUDE Degrees Minutes Seconds	
NW	° ' "	° ' "		35 ° 49 ' 53.5"	90 ° 42 ' 47 "	
NE	° ' "	° ' "				
SE	° ' "	° ' "				
SW	° ' "	° ' "				

APPROXIMATE ACREAGE OF NOMINATED PROPERTY:

LIST ALL STATES AND COUNTIES FOR PROPERTIES OVERLAPPING STATE OR COUNTY BOUNDARIES

STATE:	CODE	COUNTY	CODE
STATE:	CODE	COUNTY:	CODE
STATE:	CODE	COUNTY:	CODE
STATE:	CODE	COUNTY:	CODE

11. FORM PREPARED BY

NAME AND TITLE: Jack E. Porter, Administrator		DATE March 1973
ORGANIZATION Arkansas Historic Preservation Program		
STREET AND NUMBER: 1023 West Third		
CITY OR TOWN: Little Rock	STATE Arkansas	CODE 05

12. STATE LIAISON OFFICER CERTIFICATION

NATIONAL REGISTER VERIFICATION

As the designated State Liaison Officer for the National Historic Preservation Act of 1966 (Public Law 89-665), I hereby nominate this property for inclusion in the National Register and certify that it has been evaluated according to the criteria and procedures set forth by the National Park Service. The recommended level of significance of this nomination is:

National ☐ State ☐ Local ☒

Name William E. Henderson

Title State Liaison Officer

Date _____

I hereby certify that this property is included in the National Register.

 Director, Office of Archeology and Historic Preservation

Date _____

ATTEST:

 Keeper of The National Register

Date _____

NATIONAL REGISTER OF HISTORIC PLACES
INVENTORY - NOMINATION FORM

(Continuation Sheet)

STATE Arkansas	
COUNTY Craighead	
FOR NPS USE ONLY	
ENTRY NUMBER	DATE

(Number all entries)

9. Major Bibliographical References Continued:

Hempstead, Fay. Historical Review of Arkansas.
3 vols. Chicago: The Lewis Publishing Co.,
1911.

Herndon, Dallas T. (ed.) Centennial History of
Arkansas. 3 vols. Chicago, Little Rock:
S. J. Clark Publishing Co., 1922.

Jonesboro Daily Tribune, February 1, 1940.

Jonesboro Sun, July 18, 1971.

Stuck, Charles A. The Story of Craighead County.
Jonesboro: The Hurley Co., 1960.

Williams, Harry Lee. The History of Craighead
County. Little Rock: Parke-Harper Company,
1930.

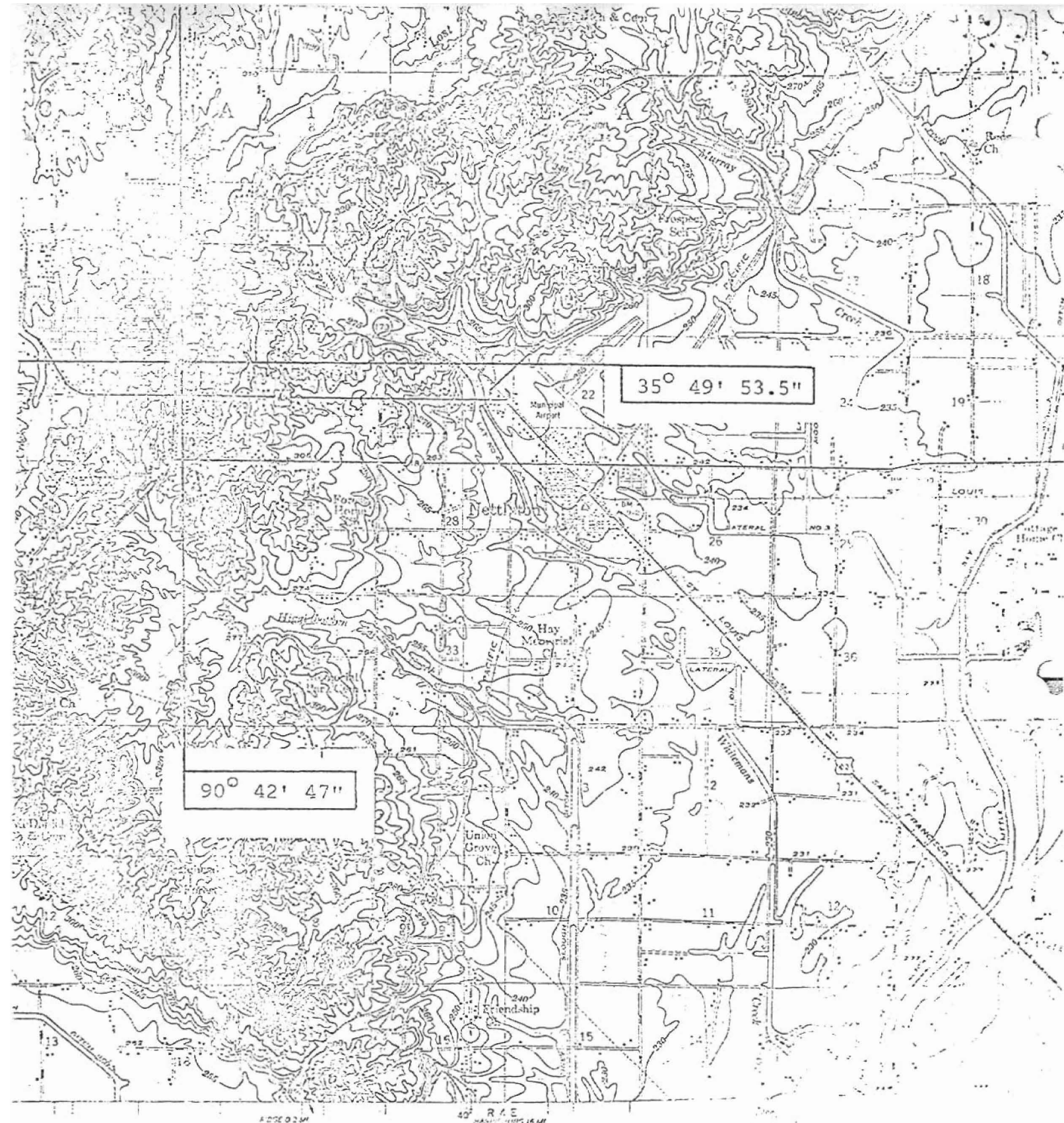

of the President, Mississippi River Commission
 strict, Memphis, Corps of Engineers.
 Mississippi River Commission, Corps of Engineers,
 lppil.
 inear District, Memphis, Corps of Engineers,
 Survey.
 th American Datum.
 odetic positions of permanent survey marks may be
 Engineer District, Memphis, Corps of Engineers, Memphis, Tenn.
 nd plane table surveys, 1957.
 7. Planimetry and Topography field checked 1957.
 according to best available information.
 shown as of March 1957.
 of map accuracy standards.

