

# Exploring Arkansas's Wonder:

**An Adventure in  
Historic Preservation**

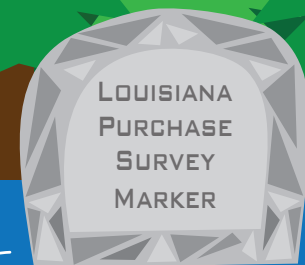

***This publication is produced by the  
Arkansas Historic Preservation Program,  
an agency of the Department of Arkansas Heritage.***

1100 North Street  
Little Rock, AR 72201  
501-324-9880  
Arkansaspreservation.com



.....  
*Concept and Writing*  
**Amy Milliken**

*Graphic Design*  
**Lori Barlow**

*Illustrations*  
**Mike Spigner**  
.....

Arkansas is full of exciting places and history. Diana the butterfly wants to take a trip to learn more about her home state. Let's follow her journey!

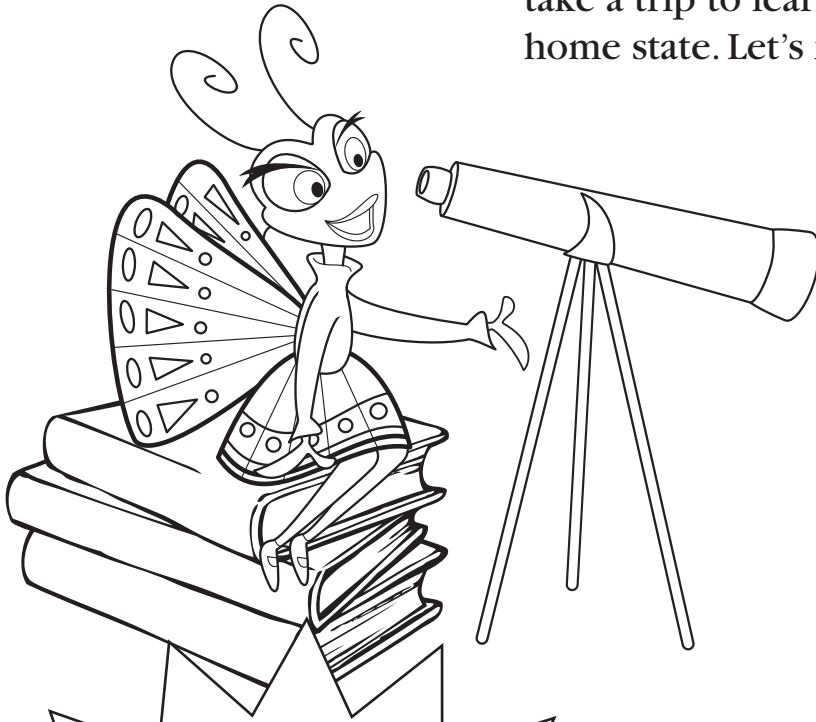

### **FUN FACT:**

The Arkansas State Butterfly is the Diana Fritillary. Females are black and blue. Males are black and orange. Arkansas is the only state to choose the Diana Fritillary as its official butterfly.

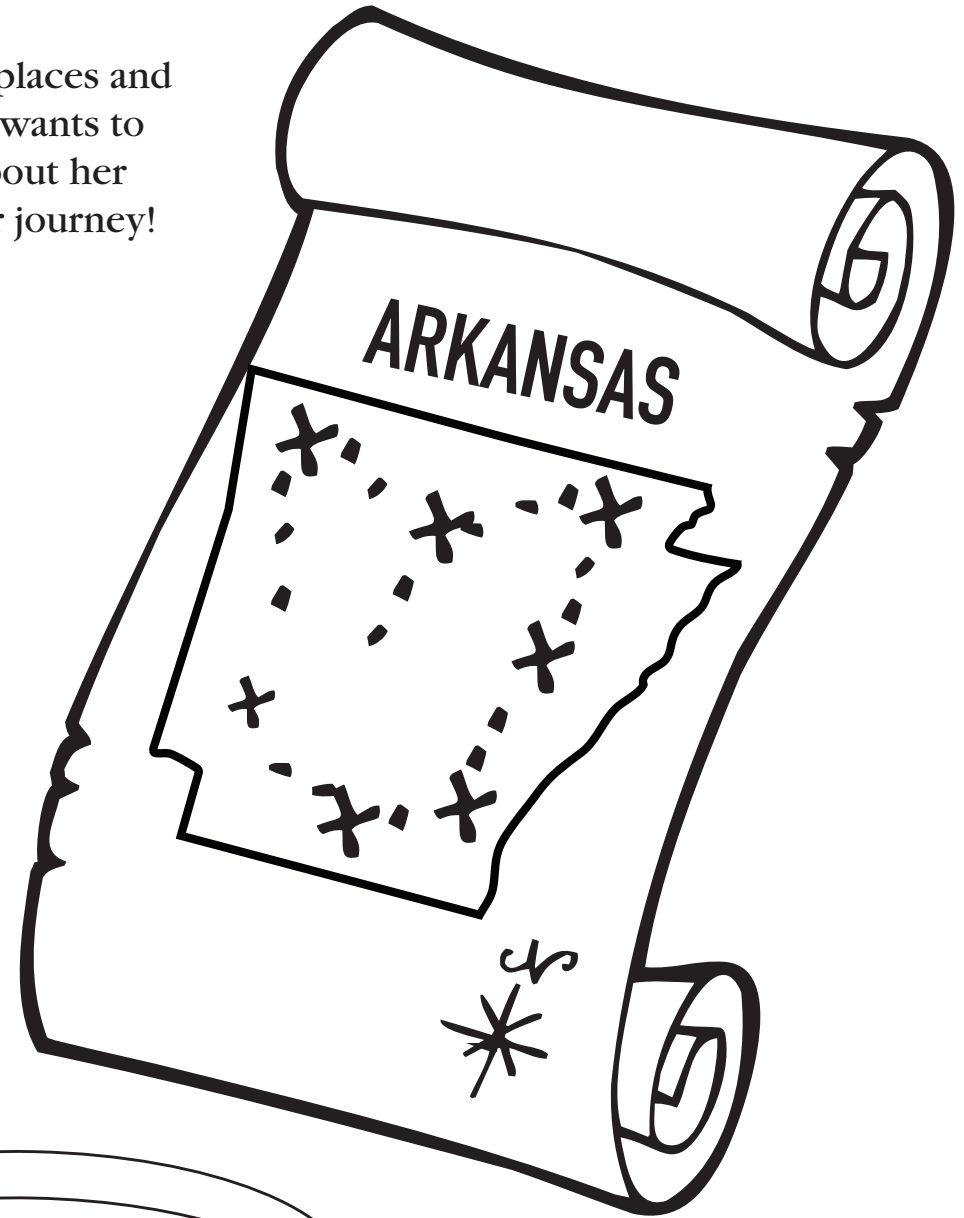

The first stop on Diana's trip of exploration is at the **Pettigrew Schoolhouse** in **Madison County**.

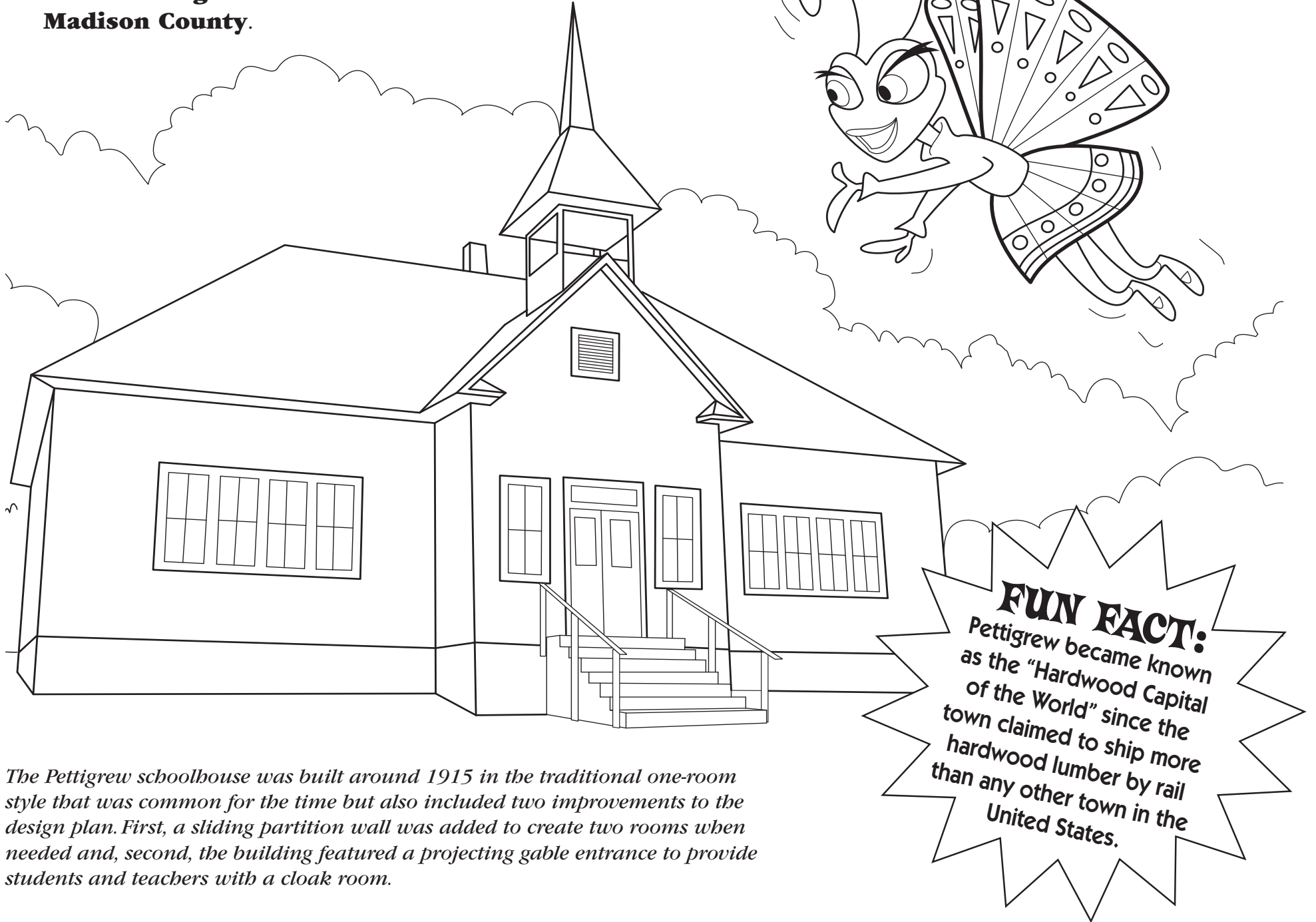

*The Pettigrew schoolhouse was built around 1915 in the traditional one-room style that was common for the time but also included two improvements to the design plan. First, a sliding partition wall was added to create two rooms when needed and, second, the building featured a projecting gable entrance to provide students and teachers with a cloak room.*

**FUN FACT:**  
Pettigrew became known as the "Hardwood Capital of the World" since the town claimed to ship more hardwood lumber by rail than any other town in the United States.



Diana's second stop on her trip is to see the **Century Flyer Train** in **Faulkner County**.

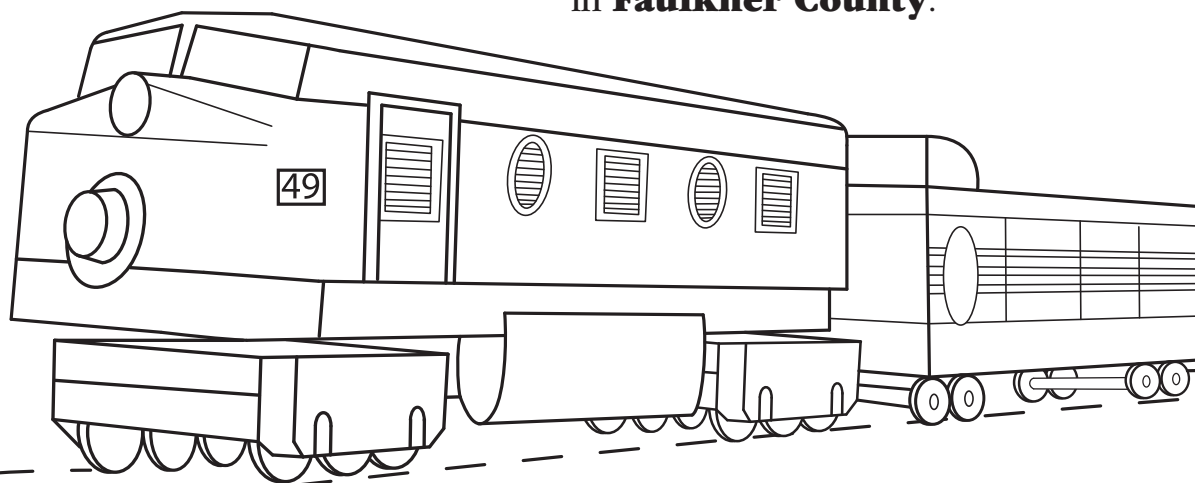

*The Century Flyer was built by the National Amusement Device Company around 1955 and was a replica of a diesel passenger engine of the period. More than one thousand of the trains were built by the company, but less than ten remain in operation today. The Faulkner County Century Flyer was originally at Burns Park in North Little Rock, but was bought and moved to the Conway Human Development Center in 1959 for the children who lived at the facility.*

**FUN  
ACTIVITY:**

Finish drawing in the railroad track so the Century Flyer can make a complete loop.

The third stop on Diana's trip is at **Historic Washington State Park** in **Hempstead County** to see the **Old Confederate State Capitol**.

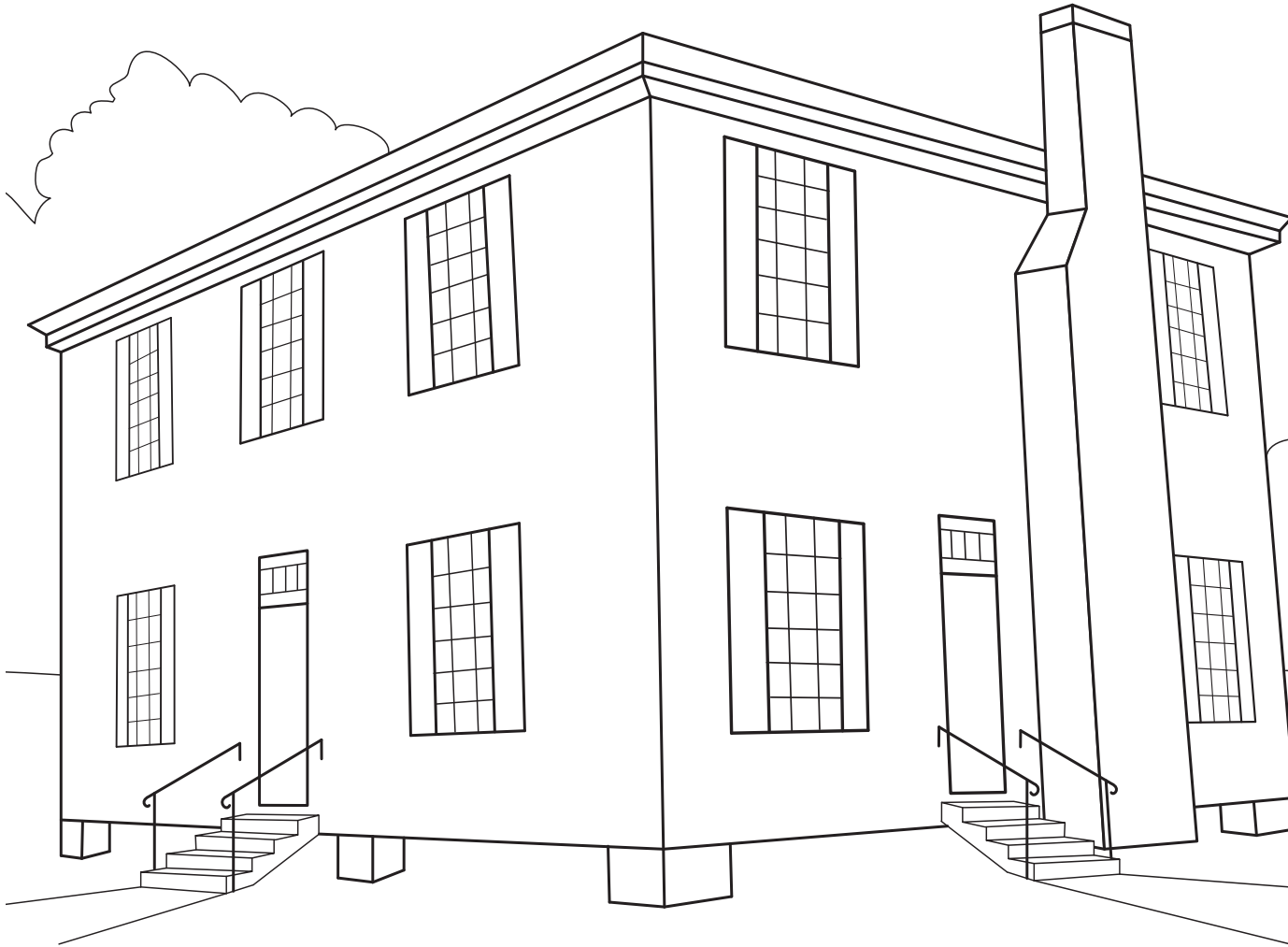

*In 1836, the new Hempstead County Courthouse was constructed. During the Civil War, Union forces occupied Little Rock and the Confederate state government was forced to move. The Hempstead County Courthouse served as the Confederate State Capitol from 1863 until the end of the war in 1865.*

**FUN  
FACT:**

In 1836, it cost \$1,850  
to build the Hempstead  
County Courthouse.

Diana's fourth stop is in **Lee County** to see the **Louisiana Purchase Survey Marker**.



## **FUN ACTIVITY:**

If you had been the explorer, what would you have written on the stone marker? Write your own inscription on the Survey Marker.

*The Louisiana Purchase Survey Marker establishes the initial point from which land surveys of the Louisiana Purchase (1803) would start. This stone monument is 6 feet tall, 4.5 feet wide at the base and usually stands in 1 foot of swamp water. The inscription reads: "This stone marks the base established November 10, 1815, from which the lands of the Louisiana Purchase were surveyed by United States engineers. The first survey from this point was made to satisfy the claims of the soldiers of the War of 1812 with land bounties."*



Diana's fifth stop on her trip of exploration is in **Logan County** to see the **Anhalt Barn**.

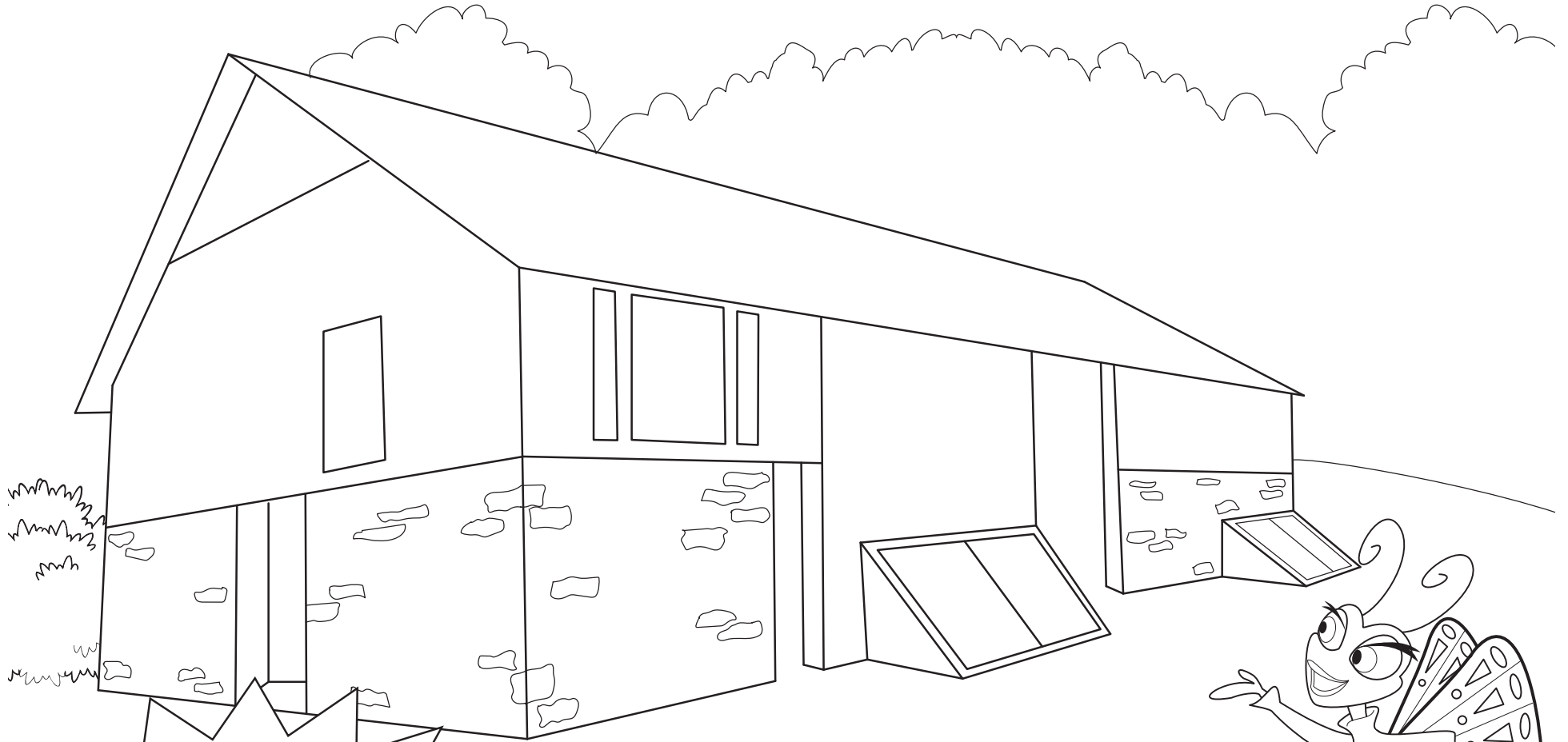

**FUN FACT:**

This barn type has been commonly found throughout western Europe for centuries.

*The Anhalt Barn is a 1 1/2 story, double-crib, wood frame and stone hay storage barn. This barn was built in 1878 by George Henry Anhalt, Sr., and is in remarkably good condition for a structure this old.*





Diana's sixth stop is to explore the **Shady Lake Recreation Area** in **Polk County**.

*The Shady Lake Recreation Area Historic District is located in the southern portion of the Ouachita National Forest. The area was developed by the U.S. Forest Service, and the Civilian Conservation Corps built many of the park's structures. Some features of the area include a bathhouse, caretaker's house, picnic pavilion, 2 stone bridges, a diving dock, grassy beach, amphitheater, biking trail, the Shady Lake Dam and overlook.*

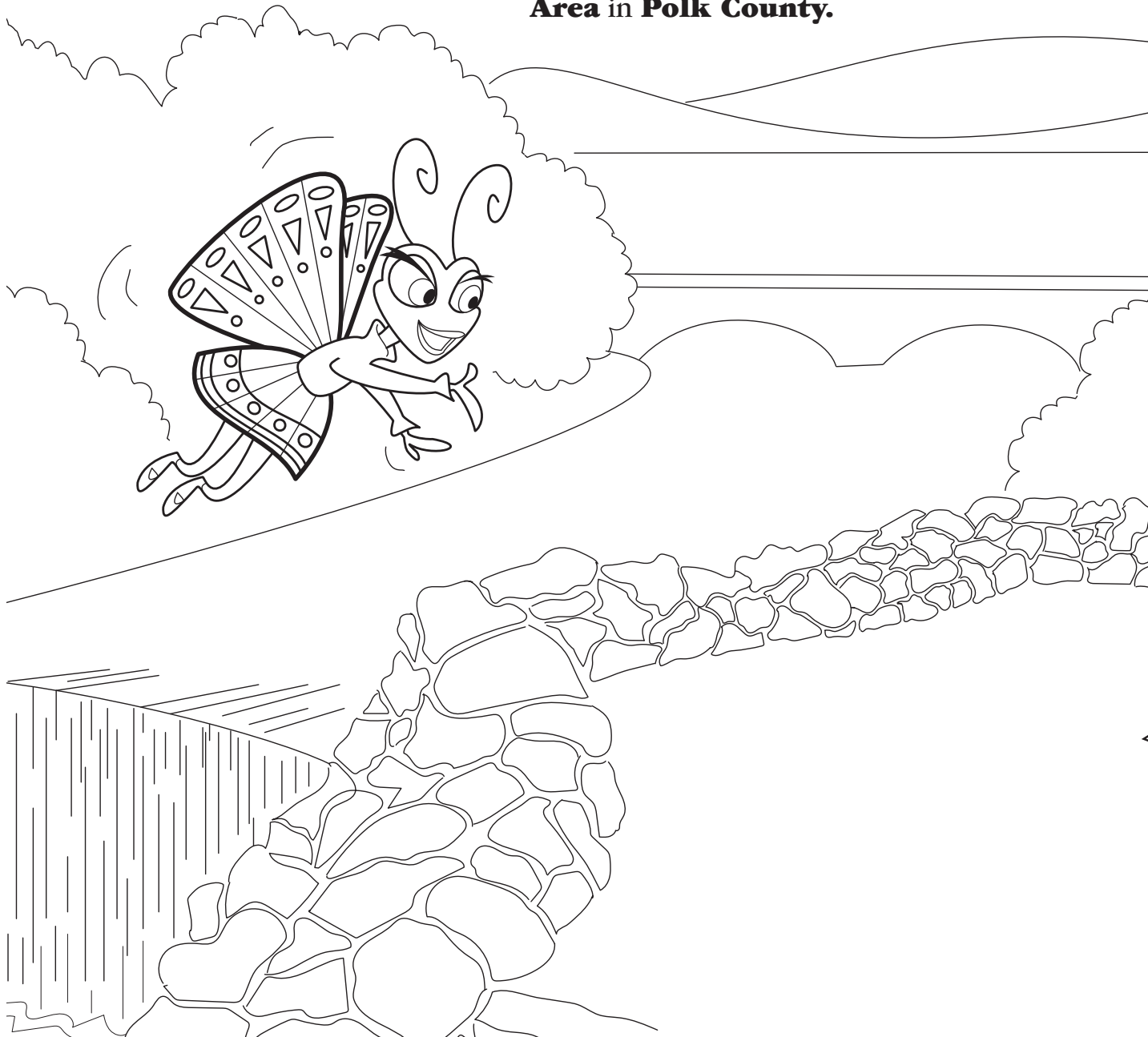

**FUN  
ACTIVITY:**

Draw you and your family playing at Shady Lake. You might be standing on the overlook or swimming in the water.

The seventh stop on Diana's trip of exploration is the **Jacob Wolf House** in **Baxter County**.



**FUN  
FACT:**

The Wolf House served as a courthouse and as the Wolf family home.

*The Jacob Wolf House was built in 1829 when Arkansas was still a United States territory. The structure was the first permanent courthouse for the county, and circuit court sessions met here several times a year. These sessions drew people from all over the county and often lasted more than a week.*



The eighth stop on Diana's trip of exploration is to see the Native American pictographs at **Petit Jean State Park** in **Conway County**.

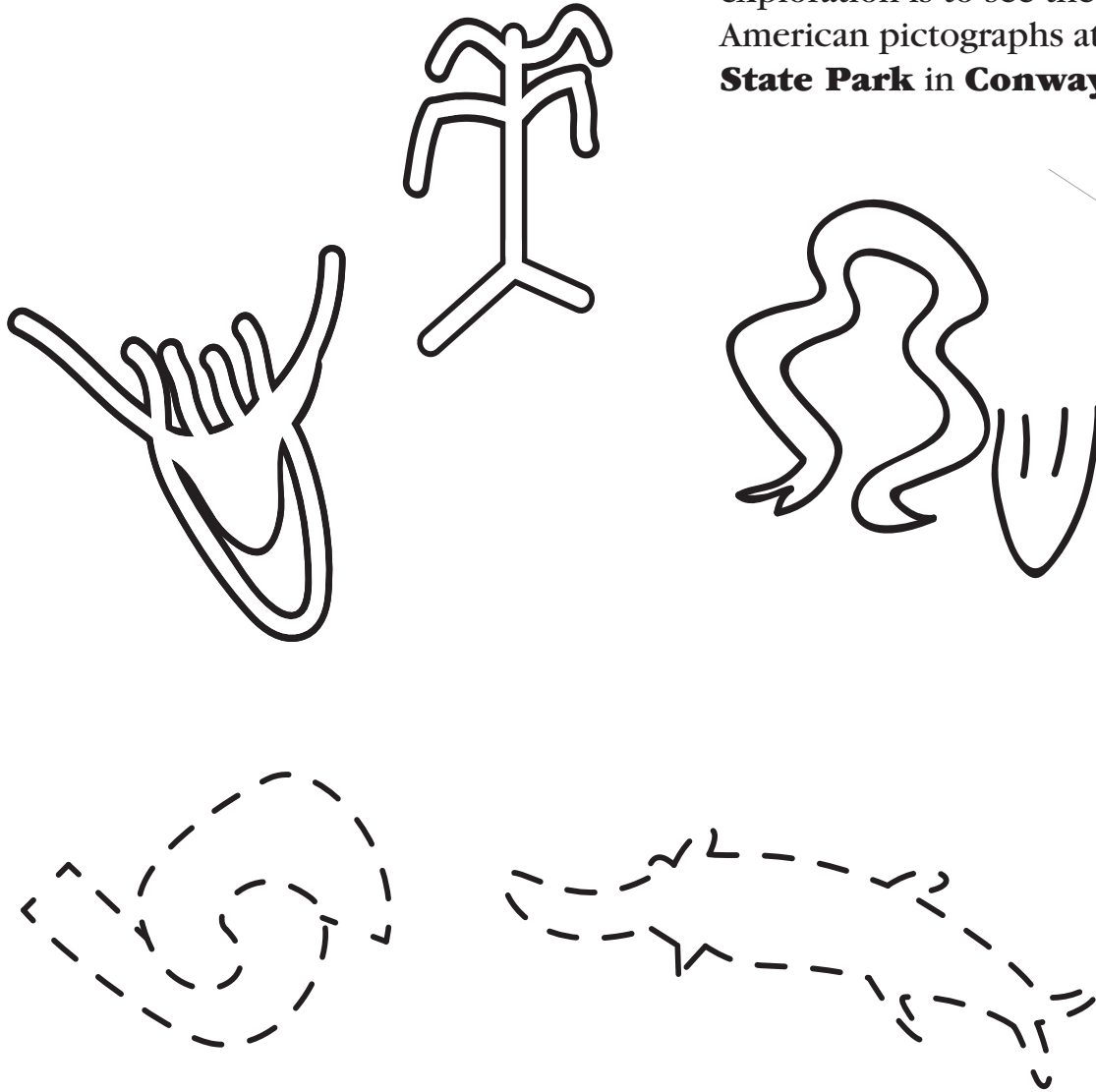

*Rock House Cave in Petit Jean State Park has prehistoric rock art called pictographs. It is believed that Native Americans visited this site between 8000 B.C. and 1600 A.D. Although no one can say what the images mean, it is assumed they represent stories or ideas meaningful to the artist.*



### **FUN ACTIVITY:**

If you were the creator of these pictographs, what meanings would you have given them? Connect the dots on the pictographs to complete the images. Draw your own rock art pictographs on the next page.

**FUN  
ACTIVITY:**

Draw your own rock art  
pictographs on this page.



Diana's ninth stop is in  
**Mississippi County** to  
explore the **Greyhound  
Bus Station.**

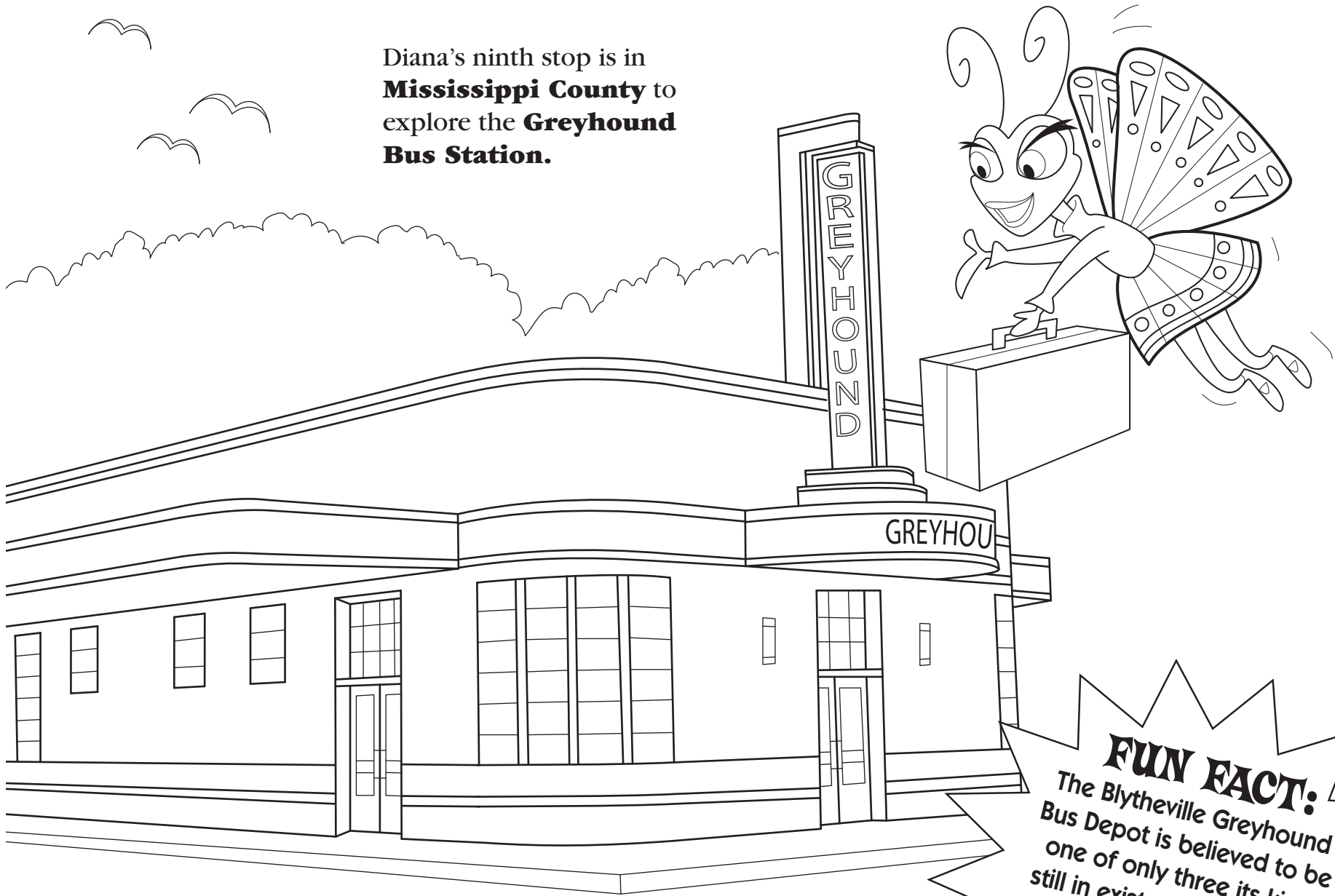

*The Greyhound Bus Station was built in 1938 by Ben Watson White in the Art Deco architectural style. Today, the building is known as the Historic Greyhound Bus Depot Visitor Center and provides tourists with information on local attractions and events.*

**FUN FACT:**  
The Blytheville Greyhound Bus Depot is believed to be one of only three its kind still in existence. The other two are located in Evansville, Indiana, and Jackson, Tennessee.

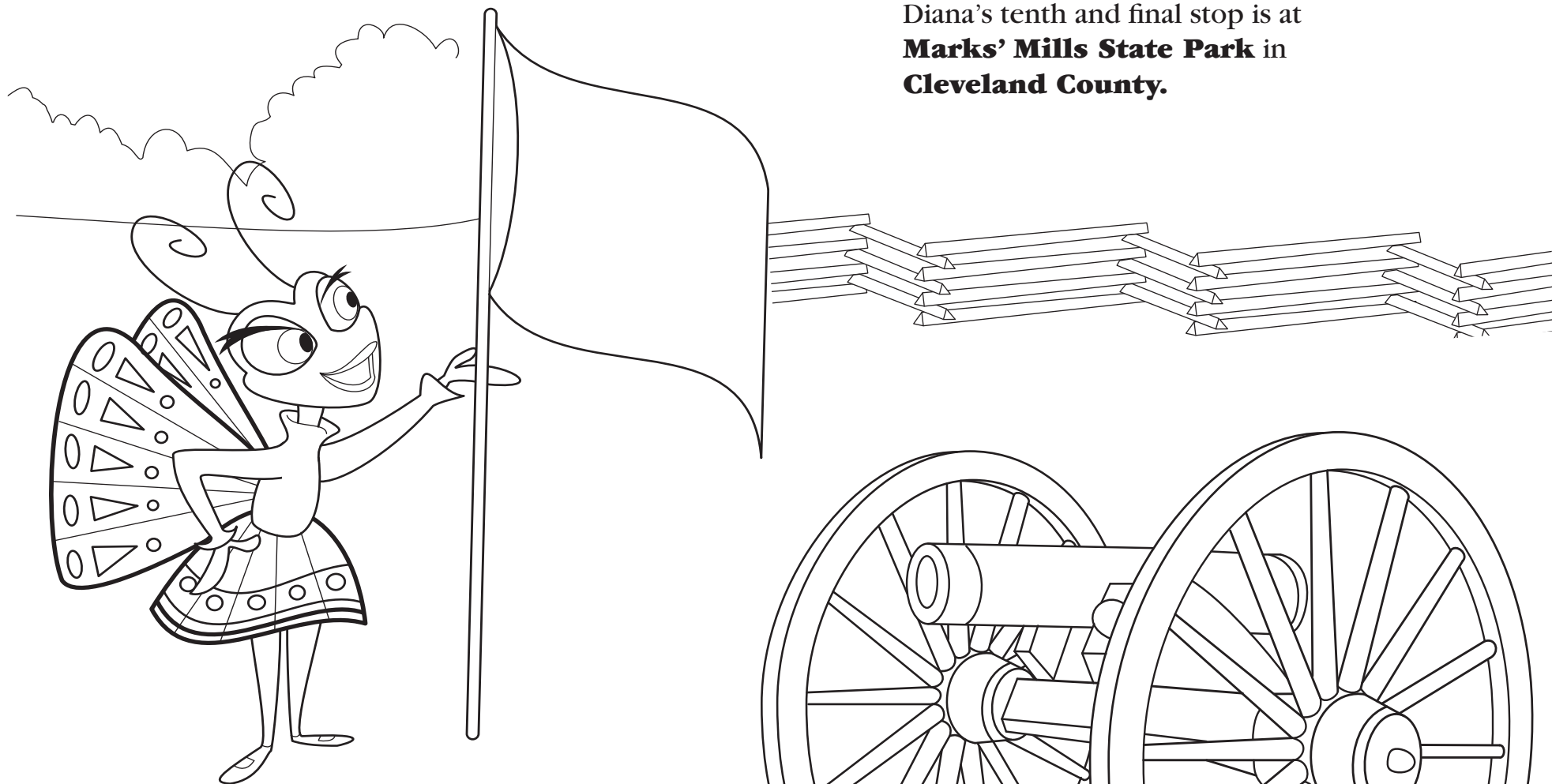

Diana's tenth and final stop is at  
**Marks' Mills State Park** in  
**Cleveland County.**

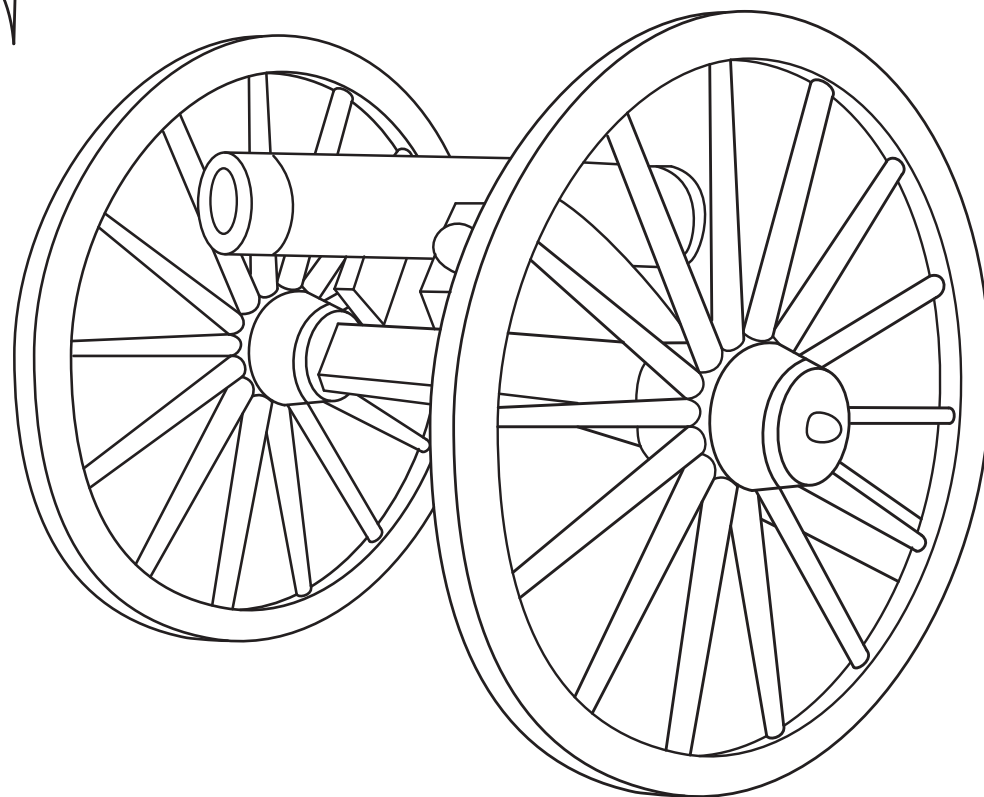

*The Battle of Marks' Mills was fought April 25, 1864. Confederate troops won the battle and the Union army suffered 1,500 casualties, most of them prisoners of war. Over the years, artifacts such as mini-balls, spurs, bullets, cannonball fragments and buckles have been found at the park. Today you can visit the Marks' Mills State Park to learn about the battle and explore the six acres of battlefield that have been preserved.*

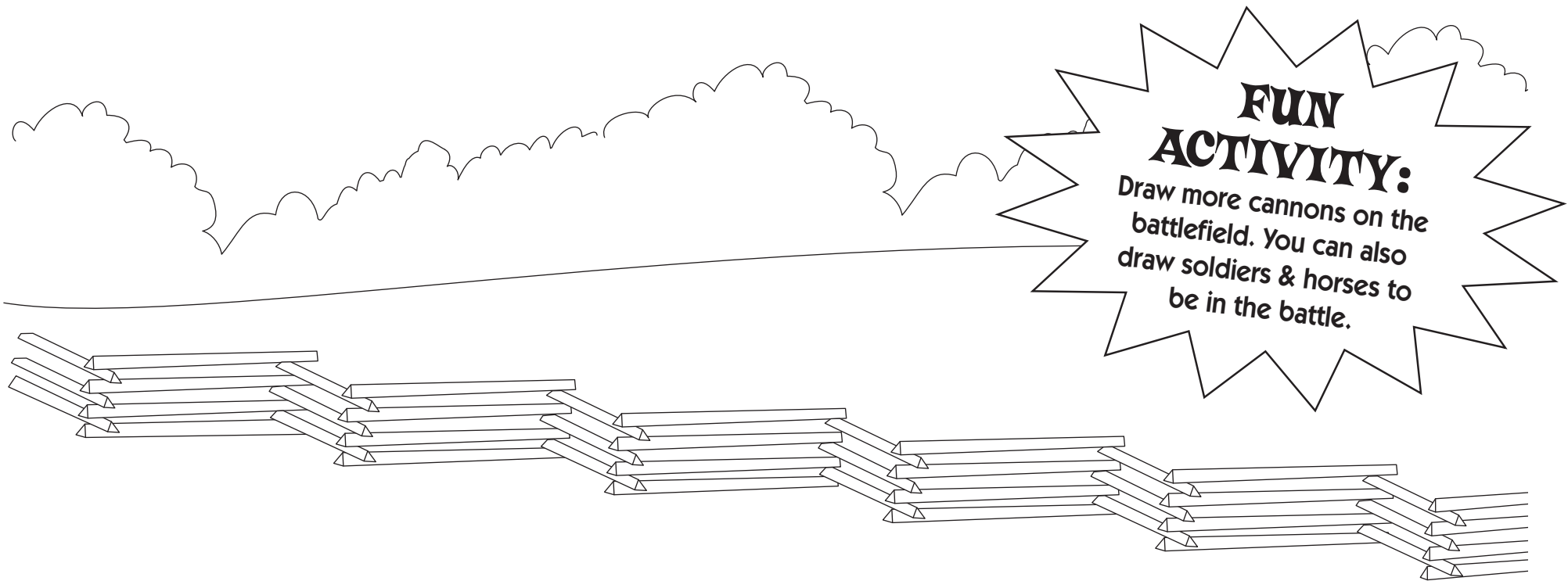



# What happened, when?

Use what you've learned following Diana's journey to make a timeline of when each building was constructed. Find the date by reading through the book, then write the name of the building in the box.

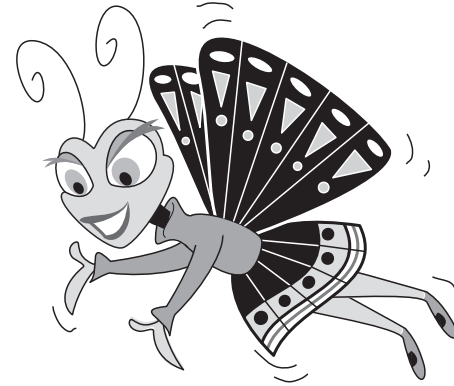

1850	NEW VERSION TO COME			

# WORD SEARCH

# Trace Diana's Journey of Arkansas's Wonders

Number the places that Diana went on her journey in the order she visited them. Then, draw a line from each number to the next.

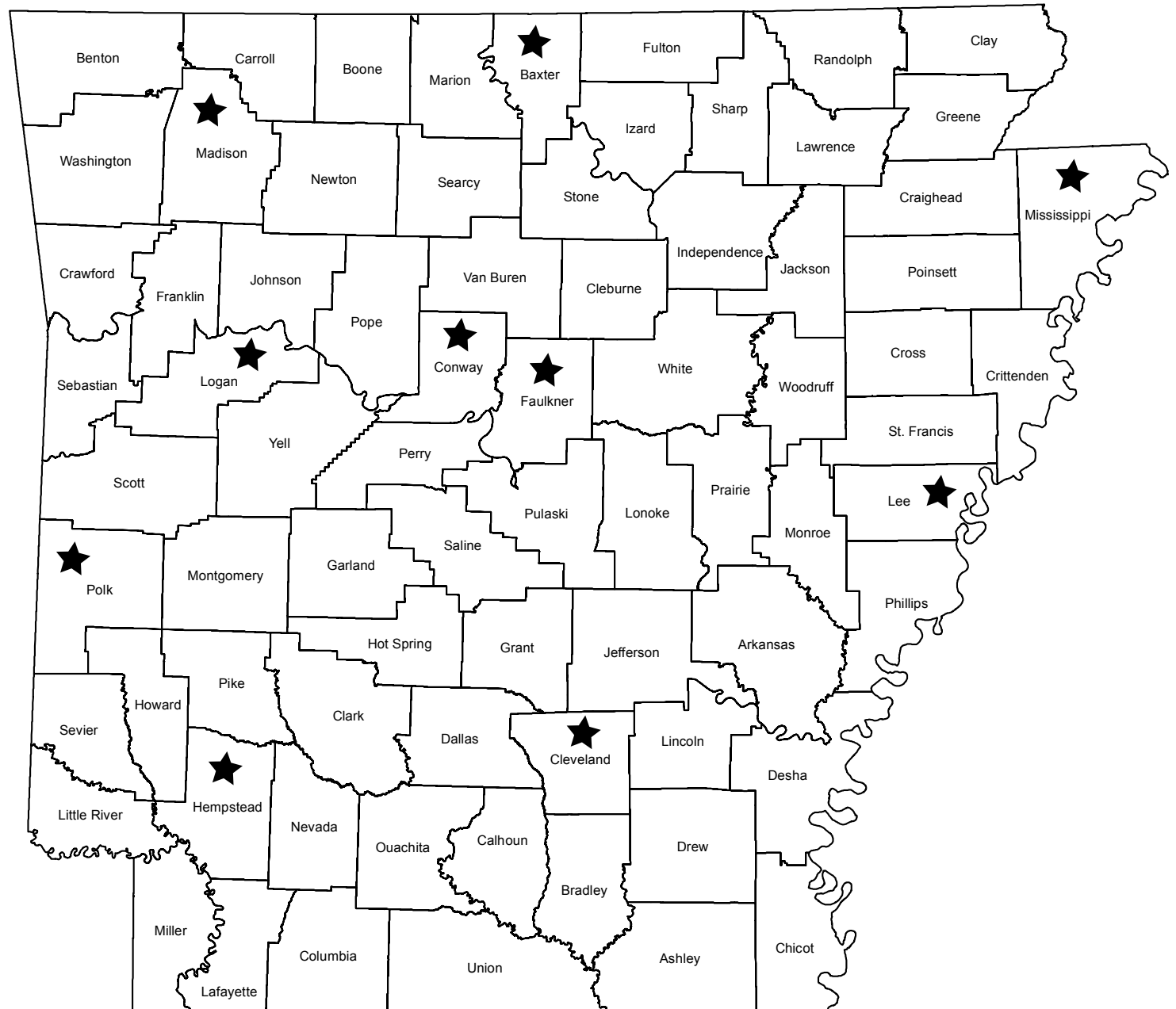

# Learn Your Facts!

Read the “Facts” on each page and answer the following questions.

Who tried Wild West outlaws for crimes at the Fort Smith National Historic Site?	
What stone found in Arkansas is used to make aluminum?	
How many mills have been at War Eagle since 1832?	
How many courthouses did Frank W. Gibb design in Arkansas?	
What is the Hemingway-Pfeiffer House used for?	
What two towns are in Pope County?	
Who donated the land for the U.S. Army Training Site in Pope County?	
Where does the limestone come from that was used to build the U.S. Post Office and Courthouse in Miller County? Where does the limestone come from?	
What is the National Guard Armory in Independence County used for now?	
How many days did it take to build and set up the Old South Restaurant in Pope County?	

INSIDE BACK COVER —  
LEFT BLANK



# Exploring Arkansas's Wonder!

Arkansas is full of exciting places and history.

Take a trip around the state to learn about some of the state's amazing historic sites in Madison, Faulkner, Hempstead, Lee, Logan, Polk, Baxter, Conway, Mississippi and Cleveland counties.

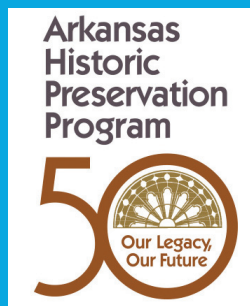

*National Historic Preservation Act  
1966-2016*

*An agency of the Department of Arkansas Heritage.*

1100 North Street  
Little Rock, AR 72201  
501-324-9880





